

KMT 2

Dimensions

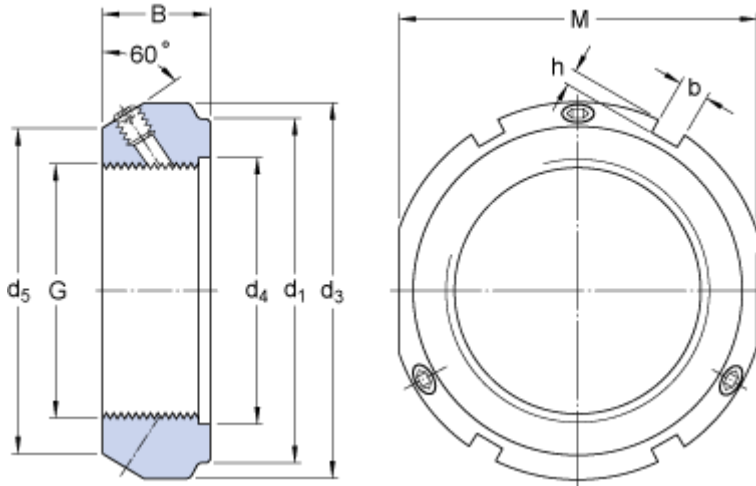

G	M 15x1	
d ₁	28	mm
B	16	mm
d ₃	33	mm
d ₄	16	mm
d ₅	26	mm
M	30	mm
b	4	mm
h	2	mm

Calculation data

Axial static load carrying capacity 60 kN

Mass

Mass 0.075 kg

Mounting information

Associated spanner (Hook spanner in accordance with DIN 1810) HN 4

Grub (set) / Locking screw size M 5

Recommended tightening torque 4.5 N·m