

KMT 10

Dimensions

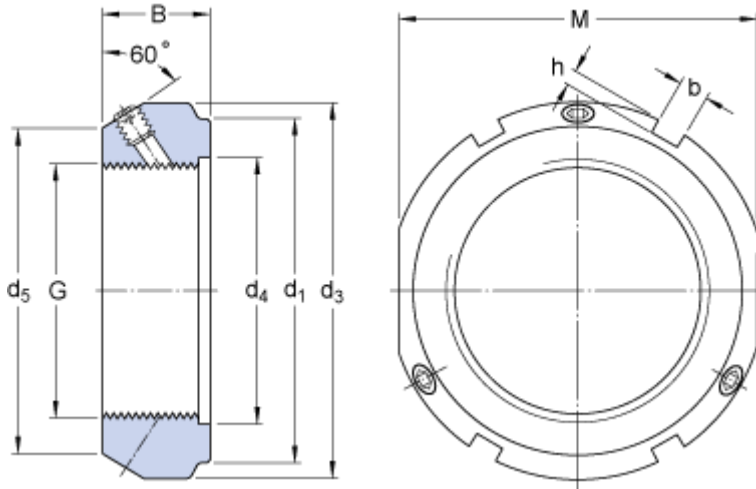

G	M 50x1.5	
d ₁	68	mm
B	25	mm
d ₃	75	mm
d ₄	52	mm
d ₅	64	mm
M	70	mm
b	7	mm
h	3	mm

Calculation data

Axial static load carrying capacity 300 kN

Mass

Mass 0.4 kg

Mounting information

Associated spanner (Hook spanner in accordance with DIN 1810) HN 10-11

Grub (set) / Locking screw size M 8

Recommended tightening torque 18 N·m