

H 311 E

Dimensions

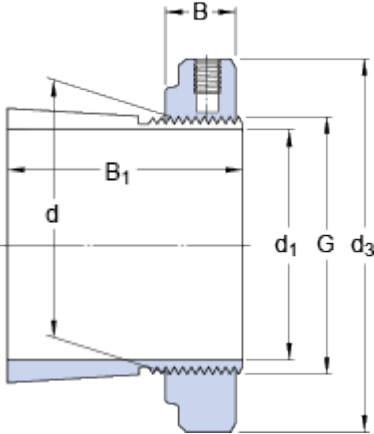

d_1	50	mm
d	55	mm
d_3	75	mm
B_1	45	mm
B	14	mm
G	M 55x2	

Mass

Mass adapter sleeve assembly

0.34

kg

Included products

Lock nut

[KMFE 11](#)

Associated products

Hydraulic nut

HMV 11 E