

GE 60 TXE-2LS

Dimensions

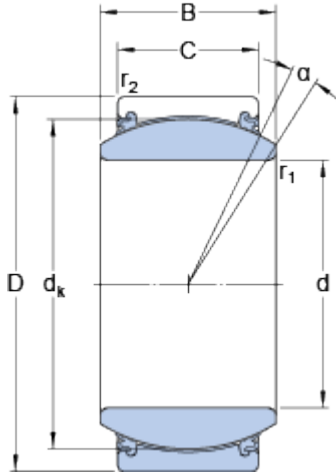

d	60	mm
D	90	mm
B	44	mm
C	36	mm
α	6	°
d_k	80	mm
r_1	min. 1	mm
r_2	min. 1	mm

Abutment dimensions

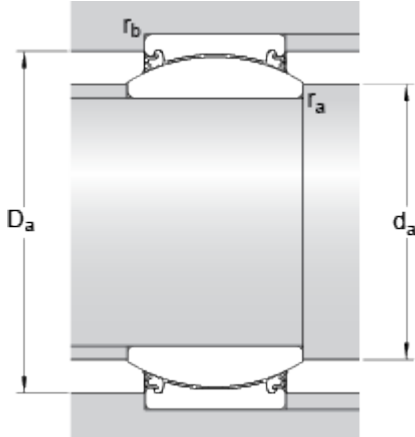

d_a	min.	66.5	mm
d_a	max.	66.8	mm
D_a	min.	80	mm
D_a	max.	84	mm
r_a	max.	1	mm
r_b	max.	1	mm

Calculation data

Basic dynamic load rating	C	695	kN
Basic static load rating	C	1160	kN
Specific dynamic load factor	K	300	N/mm ²
Specific static load factor	K	500	N/mm ²

Mass

Mass plain bearing		1	kg
--------------------	--	---	----