

# GE 35 TXG3E-2LS

## Dimensions

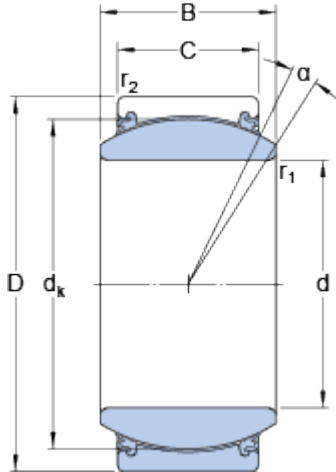

$d$	35	mm
$D$	55	mm
$B$	25	mm
$C$	20	mm
$\alpha$	6	°
$d_k$	47	mm
$r_1$	min. 0.6	mm
$r_2$	min. 1	mm

## Abutment dimensions

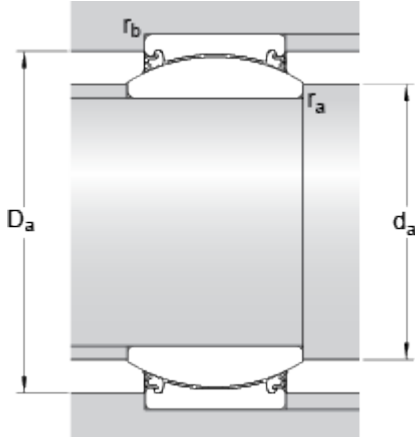

$d_a$	min. 38.5	mm
$d_a$	max. 39.8	mm
$D_a$	min. 48.5	mm
$D_a$	max. 51	mm
$r_a$	max. 0.6	mm
$r_b$	max. 1	mm

## Calculation data

Basic dynamic load rating	C	224	kN
Basic static load rating	C	375	kN
Specific dynamic load factor	K	300	N/mm <sup>2</sup>
Specific static load factor	K	500	N/mm <sup>2</sup>

## Mass

Mass plain bearing		0.23	kg
--------------------	--	------	----