

# GE 30 TXE-2LS

## Dimensions

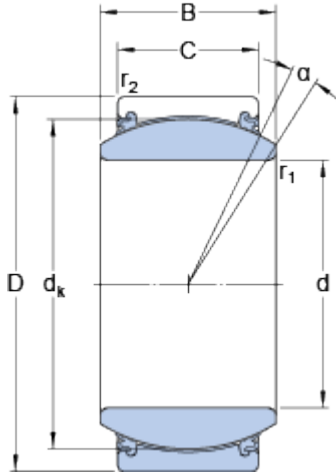

d	30	mm
D	47	mm
B	22	mm
C	18	mm
$\alpha$	6	°
$d_k$	40.7	mm
$r_1$	min. 0.6	mm
$r_2$	min. 0.6	mm

## Abutment dimensions

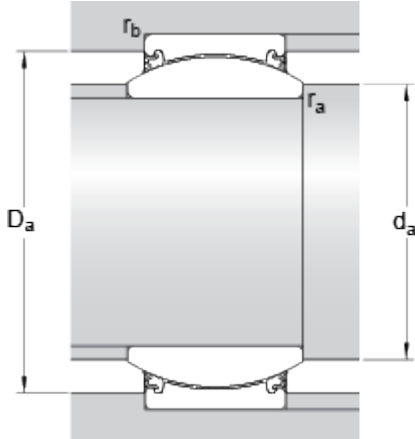

$d_a$	min.	33.3	mm
$d_a$	max.	34.2	mm
$D_a$	min.	41.3	mm
$D_a$	max.	44	mm
$r_a$	max.	0.6	mm
$r_b$	max.	0.6	mm

## Calculation data

Basic dynamic load rating	C	176	kN
Basic static load rating	C	290	kN
Specific dynamic load factor	K	300	N/mm <sup>2</sup>
Specific static load factor	K	500	N/mm <sup>2</sup>

## Mass

Mass plain bearing		0.15	kg
--------------------	--	------	----