

GAC 30 F

Dimensions

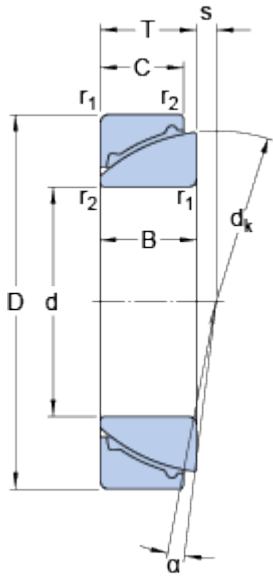

d	30	mm
D	55	mm
T	17	mm
α	3.5	°
d_k	49.5	mm
B	17	mm
C	15	mm
r_1	min. 1	mm
r_2	min. 0.3	mm
s	1.3	mm

Abutment dimensions

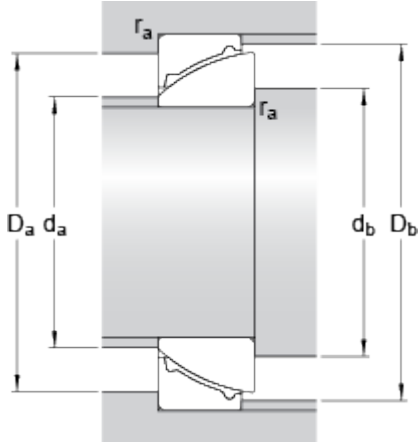

d_a	max.	35	mm
d_b	max.	45	mm
D_a	min.	39	mm
D_b	min.	50.5	mm
r_a	max.	1	mm

Calculation data

Basic dynamic load rating	C	30	kN
Basic static load rating	C	48	kN
Specific dynamic load factor	K	50	N/mm ²
Specific static load factor	K	80	N/mm ²
Material constant	K_M	480	

Mass

Mass plain bearing		0.21	kg
--------------------	--	------	----