

FY 512 M

Material

Cast iron

Dimensions

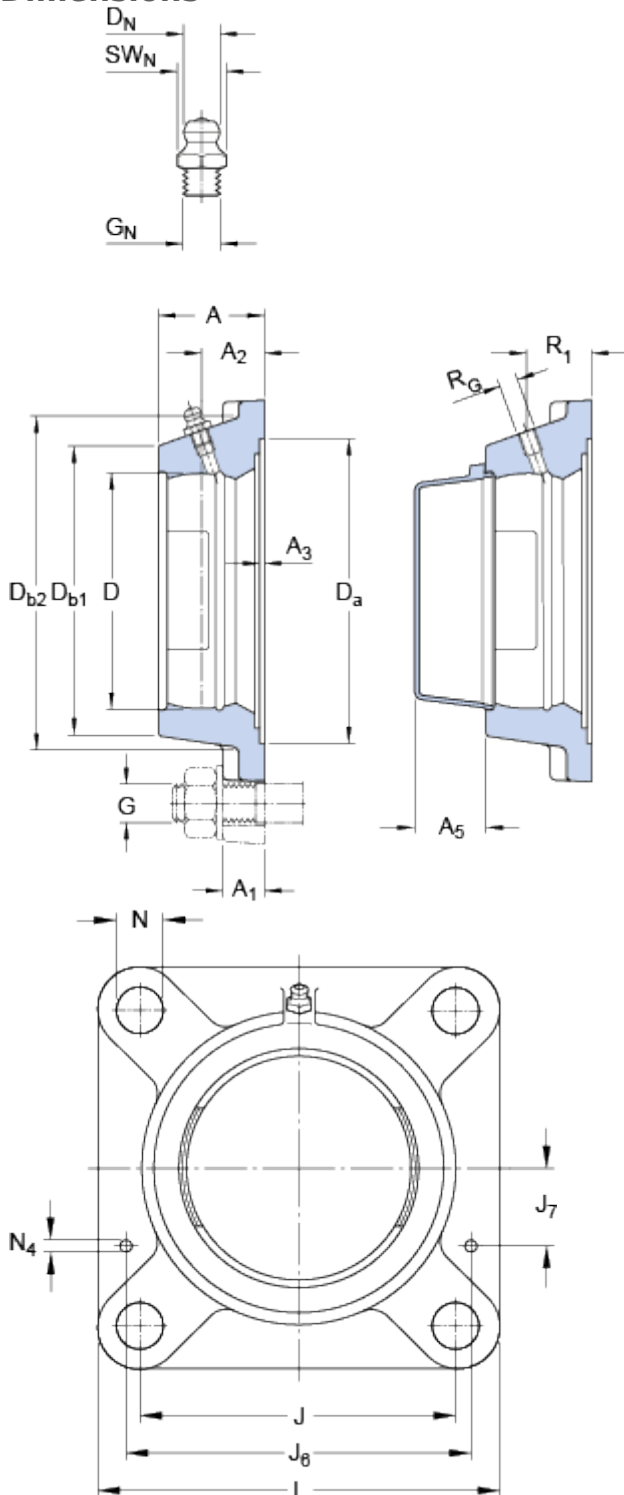

D		110	mm
D _a	H11	161.9	mm
D _{b1}		130	mm
D _{b2}		143	mm
A		52	mm
A ₁		17	mm
A ₂		34	mm
A ₃	H14	3.2	mm
A ₅		35.5	mm
J		143	mm
L		175	mm
N		18	mm

Threaded hole

R_G 1/4-28 UNF

R₁ 34.5 mm

Grease fitting

D_N 6.5 mm

SW_N 7 mm

G_N 1/4-28 SAE-LT

Dowel pins

J₆ 161 mm

J₇ 49.5 mm

N₄ 4 mm

Mass

Mass housing

2.5

kg

Mounting information

Recommended diameter for attachment bolts, mm

G

16

mm

Recommended diameter for attachment bolts, inch

G

0.625

in

Appropriate products

End cover

[ECY 212](#)

