

# FY 50 WF

Housing material

Cast iron

## Dimensions

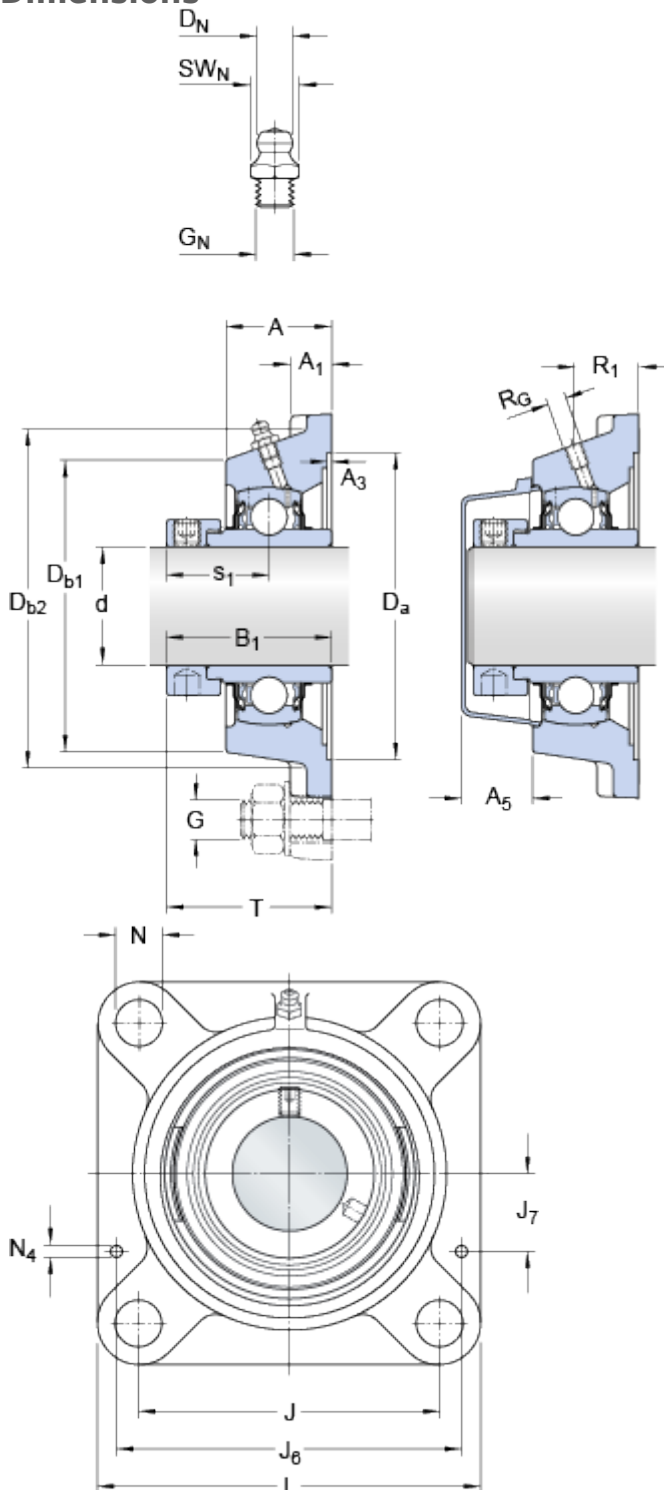

d	50	mm	
D <sub>a</sub>	H11	125.4	mm
D <sub>b1</sub>	107	mm	
D <sub>b2</sub>	118	mm	
A	43	mm	
A <sub>1</sub>	15	mm	
A <sub>3</sub>	H14	3.2	mm
A <sub>5</sub>	29.5	mm	
B <sub>1</sub>	62.7	mm	
J	111	mm	
L	143	mm	
N	18	mm	
s <sub>1</sub>	38.1	mm	
T	66.1	mm	

### Threaded hole

R<sub>G</sub> 1/4-28 UNF

R<sub>1</sub> 28.5 mm

### Grease fitting

D<sub>N</sub> 6.5 mm

SW<sub>N</sub> 7 mm

G<sub>N</sub> 1/4-28 SAE-LT

### Dowel pins

J<sub>6</sub> 129 mm

J<sub>7</sub> 35.5 mm

N<sub>4</sub> 4 mm

## Calculation data

Basic dynamic load rating

C 35.1 kN

Basic static load rating

C 23.2 kN

Fatigue load limit

P<sub>u</sub> 0.98 kN

Limiting speed

4000 r/min

(with shaft tolerance h6)

## Mass

---

Mass bearing unit	2.4	kg
-------------------	-----	----

## Mounting information

---

Thread grub screw	G <sub>2</sub>	M10x1
Hexagonal key size for grub screw	N	5 mm
Recommended tightening torque for grub screw		16.5 N·m
Recommended diameter for attachment bolts, mm	G	16 mm
Recommended diameter for attachment bolts, inch	G	0.625 in

## Included products

---

Housing	<a href="#">FY 510 M</a>
Bearing	<a href="#">YEL 210-2F</a>

## Associated products

---

End cover	<a href="#">ECY 210</a>
-----------	-------------------------