

# FY 50 FM

Housing material

Cast iron

## Dimensions

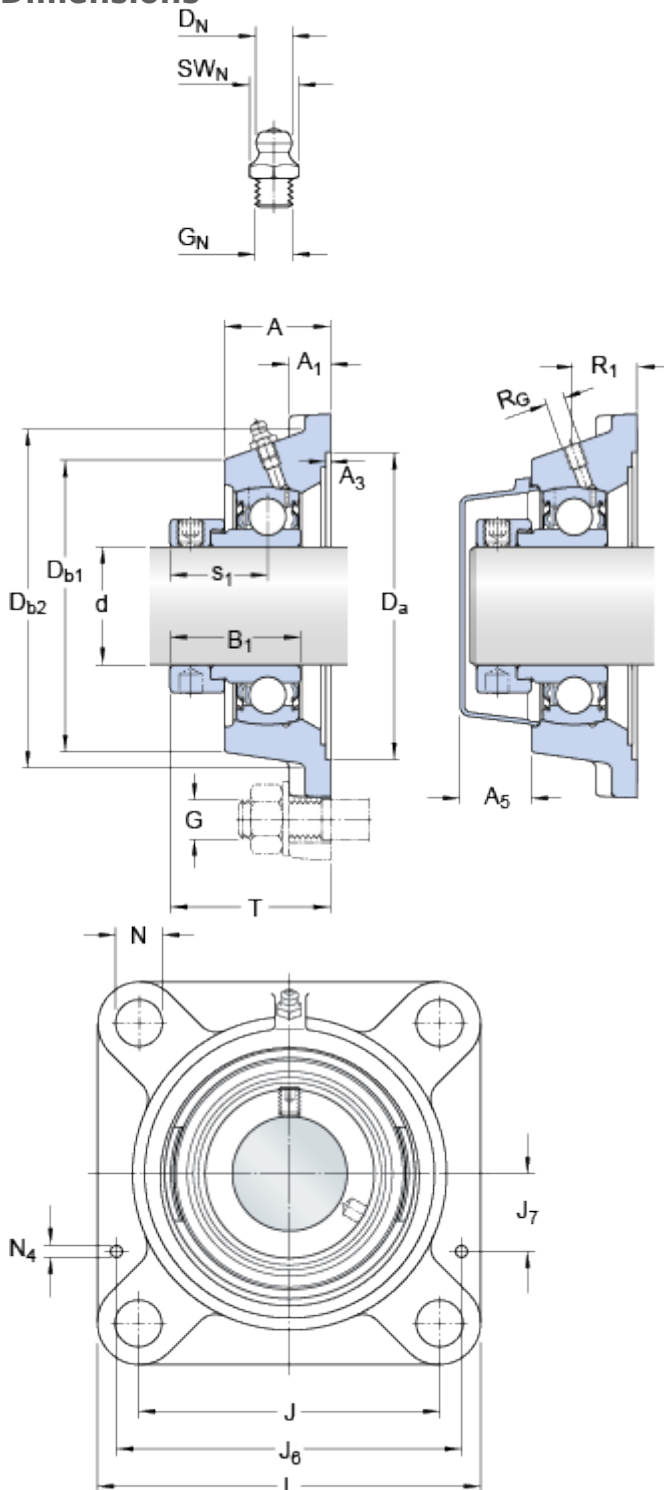

d		50	mm
D <sub>a</sub>	H11	125.4	mm
D <sub>b1</sub>		107	mm
D <sub>b2</sub>		118	mm
A		43	mm
A <sub>1</sub>		15	mm
A <sub>3</sub>	H14	3.2	mm
A <sub>5</sub>		29.5	mm
B <sub>1</sub>		43.7	mm
J		111	mm
L		143	mm
N		18	mm
S <sub>1</sub>		32.7	mm
T		60.7	mm

### Threaded hole

R <sub>G</sub>		1/4-28 UNF	
R <sub>1</sub>		28.5	mm

### Grease fitting

D <sub>N</sub>		6.5	mm
SW <sub>N</sub>		7	mm
G <sub>N</sub>		1/4-28 SAE-LT	

### Dowel pins

J <sub>6</sub>		129	mm
J <sub>7</sub>		35.5	mm
N <sub>4</sub>		4	mm

## Calculation data

Basic dynamic load rating	C	35.1	kN
Basic static load rating	C	23.2	kN
Fatigue load limit	P <sub>u</sub>	0.98	kN
Limiting speed		4000	r/min

(with shaft tolerance h6)

## Mass

---

Mass bearing unit	2.2	kg
-------------------	-----	----

## Mounting information

---

Thread grub screw	G <sub>2</sub>	M10x1
Hexagonal key size for grub screw	N	5 mm
Recommended tightening torque for grub screw		16.5 N·m
Recommended diameter for attachment bolts, mm	G	16 mm
Recommended diameter for attachment bolts, inch	G	0.625 in

## Included products

---

Housing	<a href="#">FY 510 M</a>
Bearing	<a href="#">YET 210</a>

## Assosiated products

---

End cover	<a href="#">ECY 210</a>
-----------	-------------------------