

# FY 45 FM

Housing material

Cast iron

## Dimensions

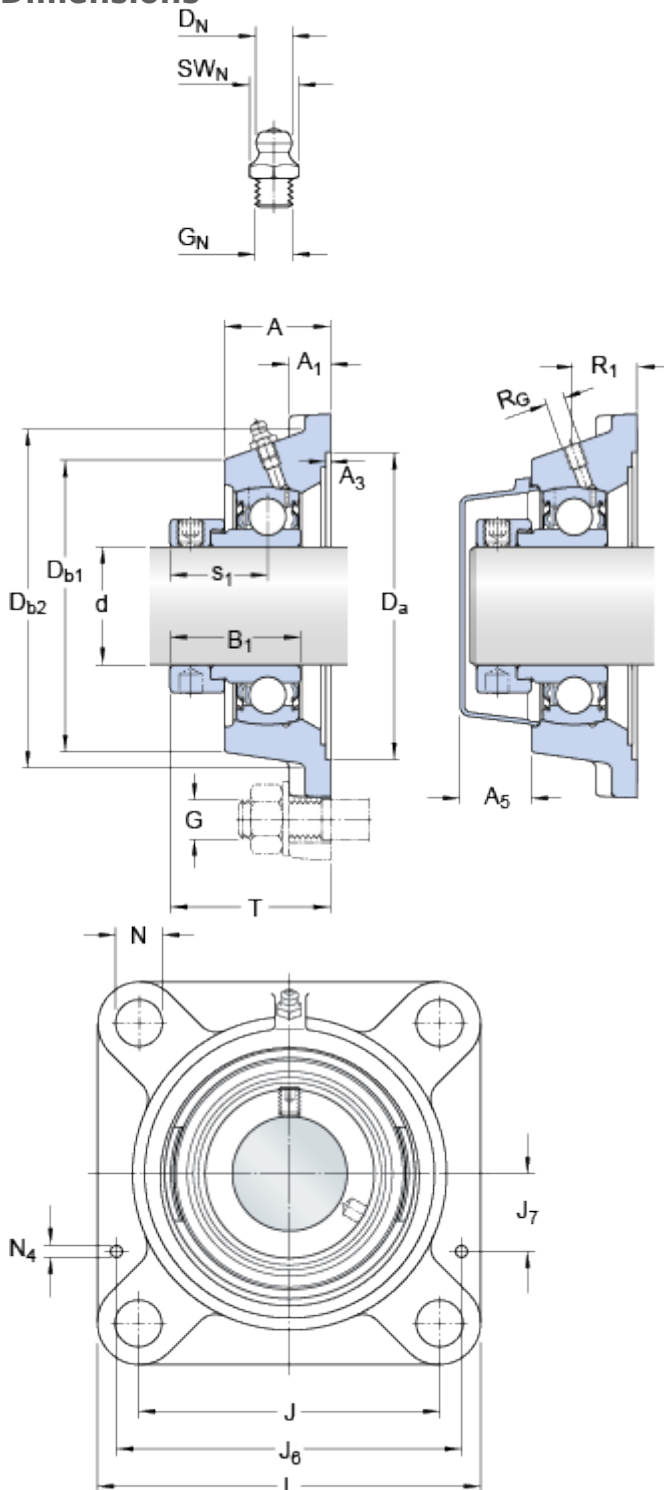

d		45	mm
D <sub>a</sub>	H11	119.1	mm
D <sub>b1</sub>		102	mm
D <sub>b2</sub>		112	mm
A		39	mm
A <sub>1</sub>		14	mm
A <sub>3</sub>	H14	3.2	mm
A <sub>5</sub>		23	mm
B <sub>1</sub>		43.7	mm
J		105	mm
L		137	mm
N		16	mm
S <sub>1</sub>		32.7	mm
T		56.7	mm

### Threaded hole

R<sub>G</sub> 1/4-28 UNF

R<sub>1</sub> 24.5 mm

### Grease fitting

D<sub>N</sub> 6.5 mm

SW<sub>N</sub> 7 mm

G<sub>N</sub> 1/4-28 SAE-LT

### Dowel pins

J<sub>6</sub> 123 mm

J<sub>7</sub> 33.5 mm

N<sub>4</sub> 4 mm

## Calculation data

Basic dynamic load rating	C	33.2	kN
Basic static load rating	C	21.6	kN
Fatigue load limit	P <sub>u</sub>	0.915	kN
Limiting speed		4300	r/min

(with shaft tolerance h6)

## Mass

---

Mass bearing unit	1.95	kg
-------------------	------	----

## Mounting information

---

Thread grub screw	G <sub>2</sub>	M10x1	
Hexagonal key size for grub screw	N	5	mm
Recommended tightening torque for grub screw		16.5	N·m
Recommended diameter for attachment bolts, mm	G	14	mm
Recommended diameter for attachment bolts, inch	G	0.5625	in

## Included products

---

Housing	<a href="#">FY 509 M</a>
Bearing	<a href="#">YET 209</a>

## Associated products

---

End cover	<a href="#">ECY 209</a>
-----------	-------------------------