

FY 40 FM

Housing material

Cast iron

Dimensions

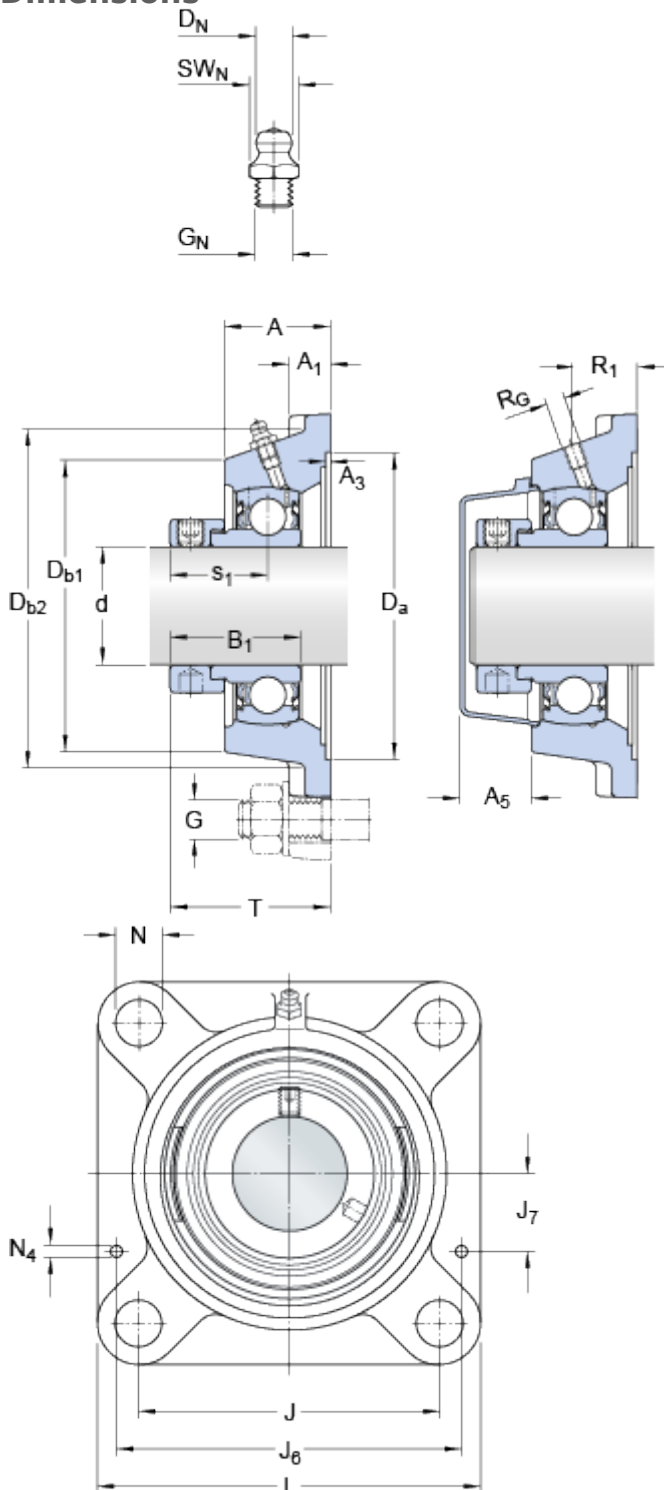

d	40	mm
D _a	H11 115.9	mm
D _{b1}	98	mm
D _{b2}	106	mm
A	38.5	mm
A ₁	14	mm
A ₃	H14 3.2	mm
A ₅	23.5	mm
B ₁	43.7	mm
J	101.5	mm
L	130	mm
N	14	mm
S ₁	33.2	mm
T	57.2	mm

Threaded hole

R _G	1/4-28 UNF
R ₁	25.5 mm

Grease fitting

D _N	6.5	mm
SW _N	7	mm
G _N	1/4-28 SAE-LT	

Dowel pins

J ₆	118	mm
J ₇	34	mm
N ₄	4	mm

Calculation data

Basic dynamic load rating	C	30.7	kN
Basic static load rating	C	19	kN
Fatigue load limit	P _u	0.8	kN
Limiting speed		4800	r/min

(with shaft tolerance h6)

Mass

Mass bearing unit	1.8	kg
-------------------	-----	----

Mounting information

Thread grub screw	G ₂	M10x1
Hexagonal key size for grub screw	N	5 mm
Recommended tightening torque for grub screw		16.5 N·m
Recommended diameter for attachment bolts, mm	G	12 mm
Recommended diameter for attachment bolts, inch	G	0.5 in

Included products

Housing	FY 508 M
Bearing	YET 208

Associated products

End cover	ECY 208
-----------	-------------------------