

# FY 35 FM

Housing material

Cast iron

## Dimensions

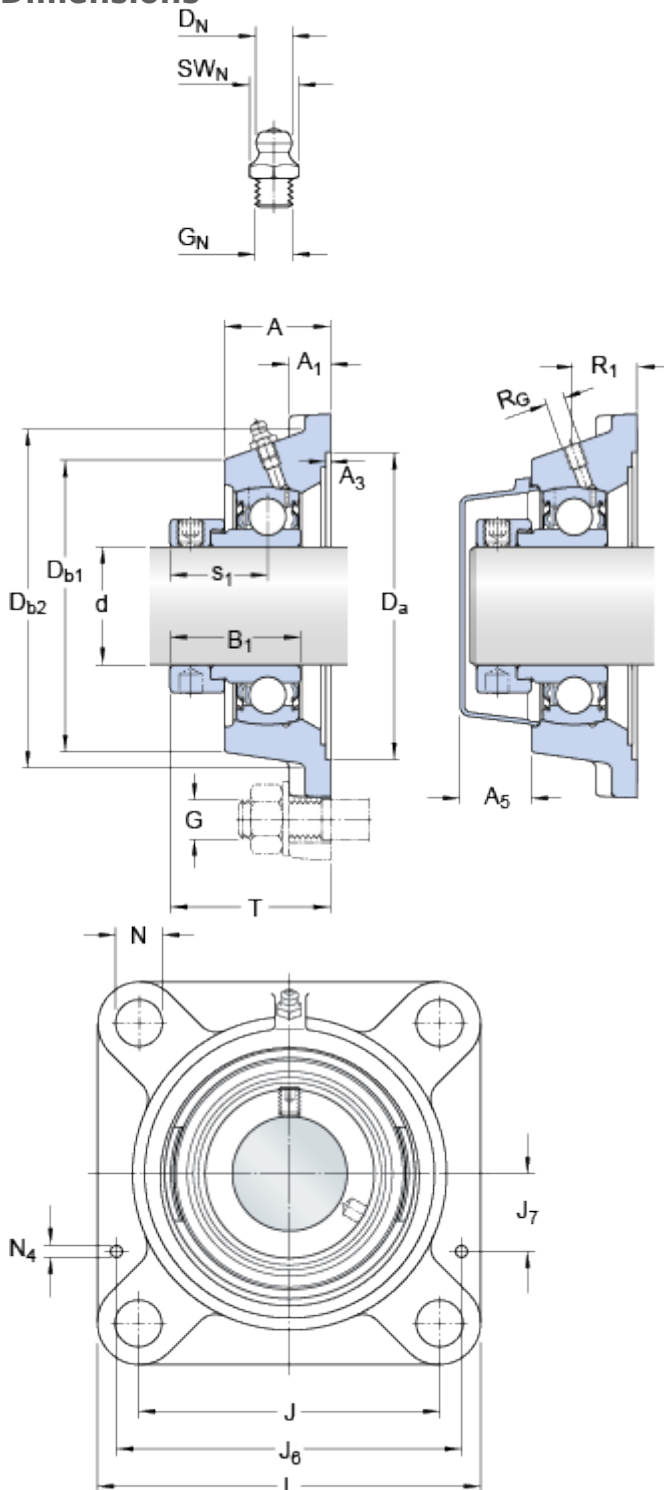

d		35	mm
D <sub>a</sub>	H11	106.4	mm
D <sub>b1</sub>		87	mm
D <sub>b2</sub>		95	mm
A		34.5	mm
A <sub>1</sub>		13	mm
A <sub>3</sub>	H14	3.2	mm
A <sub>5</sub>		22	mm
B <sub>1</sub>		38.9	mm
J		92	mm
L		118	mm
N		14	mm
S <sub>1</sub>		29.4	mm
T		50.4	mm

### Threaded hole

R <sub>G</sub>		1/4-28 UNF	
R <sub>1</sub>		22.5	mm

### Grease fitting

D <sub>N</sub>		6.5	mm
SW <sub>N</sub>		7	mm
G <sub>N</sub>		1/4-28 SAE-LT	

### Dowel pins

J <sub>6</sub>		106	mm
J <sub>7</sub>		29	mm
N <sub>4</sub>		4	mm

## Calculation data

Basic dynamic load rating	C	25.5	kN
Basic static load rating	C	15.3	kN
Fatigue load limit	P <sub>u</sub>	0.655	kN
Limiting speed		5300	r/min

(with shaft tolerance h6)

## Mass

---

Mass bearing unit	1.3	kg
-------------------	-----	----

## Mounting information

---

Thread grub screw	G <sub>2</sub>	M10x1
Hexagonal key size for grub screw	N	5 mm
Recommended tightening torque for grub screw		16.5 N·m
Recommended diameter for attachment bolts, mm	G	12 mm
Recommended diameter for attachment bolts, inch	G	0.5 in

## Included products

---

Housing	<a href="#">FY 507 M</a>
Bearing	<a href="#">YET 207</a>

## Associated products

---

End cover	<a href="#">ECY 207</a>
-----------	-------------------------