

FY 25 FM

Housing material

Cast iron

Dimensions

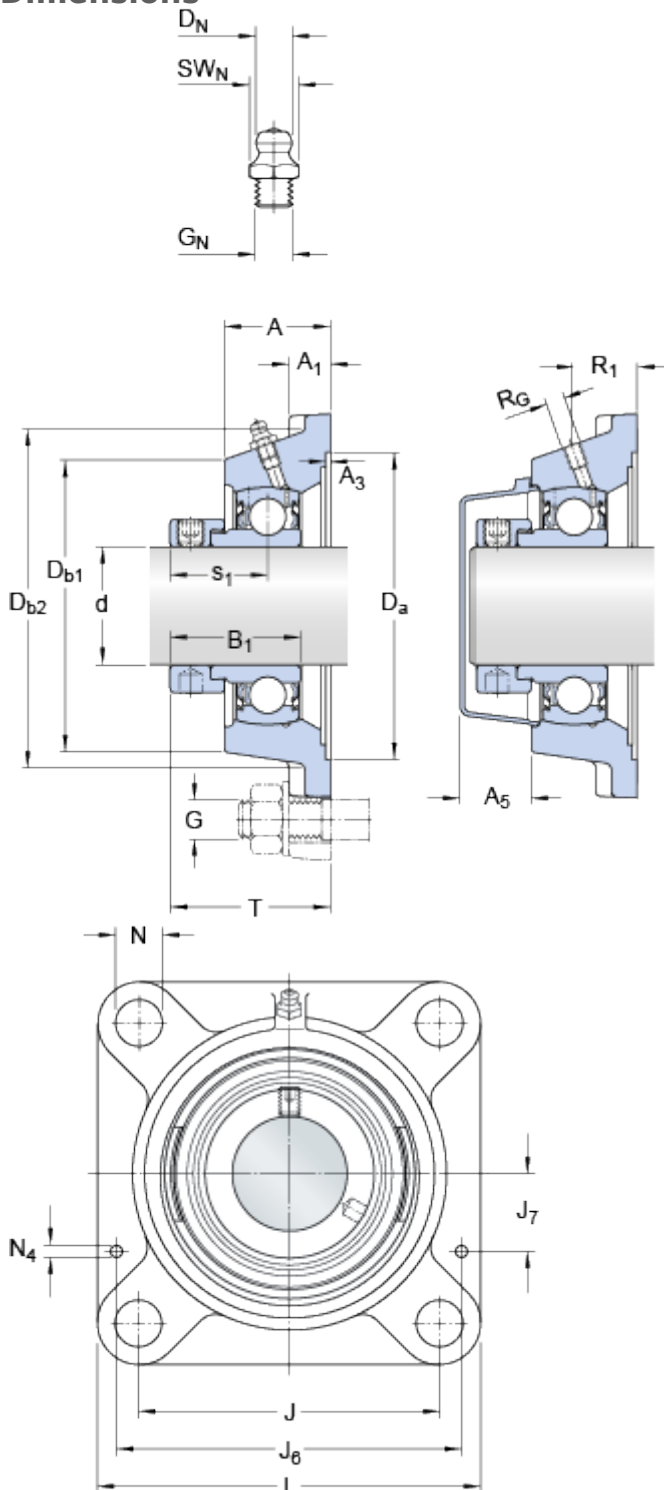

d	25	mm
D _a	H11 74.6	mm
D _{b1}	65	mm
D _{b2}	71	mm
A	30	mm
A ₁	12	mm
A ₃	H14 3.2	mm
A ₅	18	mm
B ₁	31	mm
J	70	mm
L	95	mm
N	11.5	mm
S ₁	23.5	mm
T	42.5	mm

Threaded hole

R _G	1/4-28 UNF
R ₁	21 mm

Grease fitting

D _N	6.5	mm
SW _N	7	mm
G _N	1/4-28 SAE-LT	

Dowel pins

J ₆	83	mm
J ₇	19	mm
N ₄	4	mm

Calculation data

Basic dynamic load rating	C	14	kN
Basic static load rating	C	7.8	kN
Fatigue load limit	P _u	0.335	kN
Limiting speed		7000	r/min

(with shaft tolerance h6)

Mass

Mass bearing unit	0.7	kg
-------------------	-----	----

Mounting information

Thread grub screw	G ₂	M6x0.75
Hexagonal key size for grub screw	N	3 mm
Recommended tightening torque for grub screw		4 N·m
Recommended diameter for attachment bolts, mm	G	10 mm
Recommended diameter for attachment bolts, inch	G	0.375 in

Included products

Housing	FY 505 M
Bearing	YET 205

Associated products

End cover	ECY 205
-----------	-------------------------