

# FYTWK 40 LTA

Housing material

Composite for food and beverage

## Dimensions

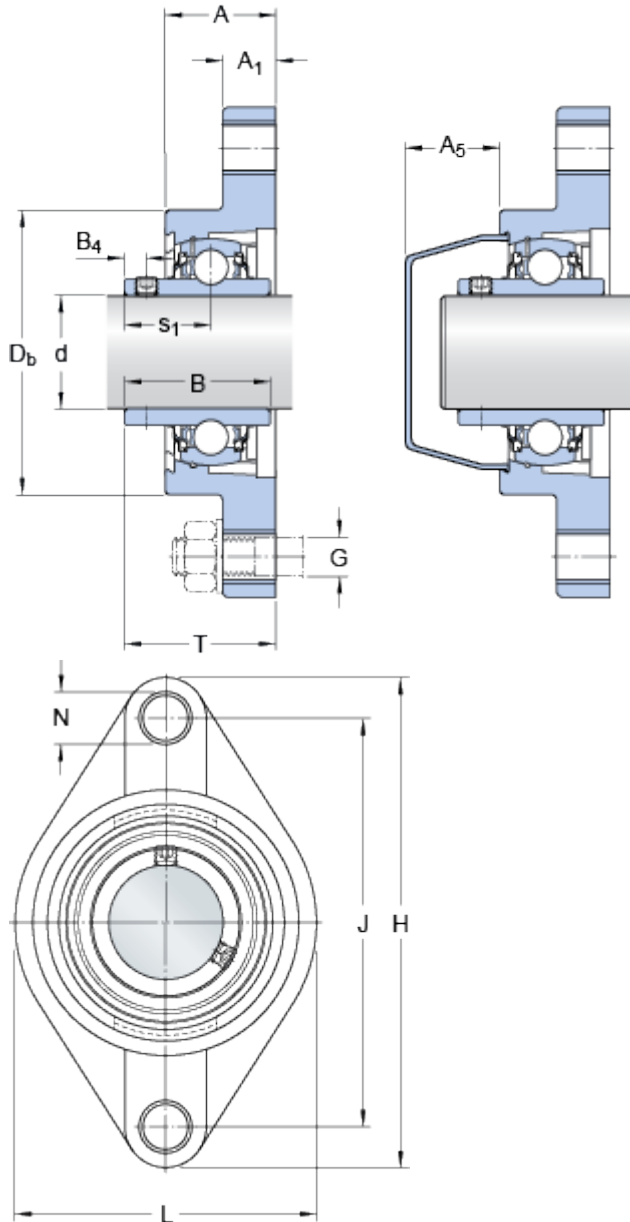

d	40	mm
$D_b$	100	mm
A	37.5	mm
$A_1$	20	mm
$A_5$	33.5	mm
B	49.2	mm
$B_4$	8	mm
J	144	mm
H	175	mm
L	100	mm
N	14	mm
$s_1$	30.2	mm
T	51.7	mm

## Calculation data

Basic dynamic load rating	C	30.7	kN
Basic static load rating	C	19	kN
Fatigue load limit	$P_u$	0.8	kN
Limiting speed		2800	r/min
(with shaft tolerance h6)			

## Mass

Mass bearing unit		0.86	kg
-------------------	--	------	----

## Mounting information

Thread grub screw	$G_2$	M8x1
Hexagonal key size for grub screw	N	4 mm

Recommended tightening torque for grub screw		6.5	N·m
Recommended diameter for attachment bolts, mm	G	12	mm
Recommended diameter for attachment bolts, inch	G	0.5	in

### Included products

---

Housing	<a href="#">FYTWK 508 L</a>
Bearing	<a href="#">YAR 208-2RF/VE495</a>

### Assosiated products

---

End cover	<a href="#">ECL 208</a>
-----------	-------------------------