

FYTJ 506

Dimensions

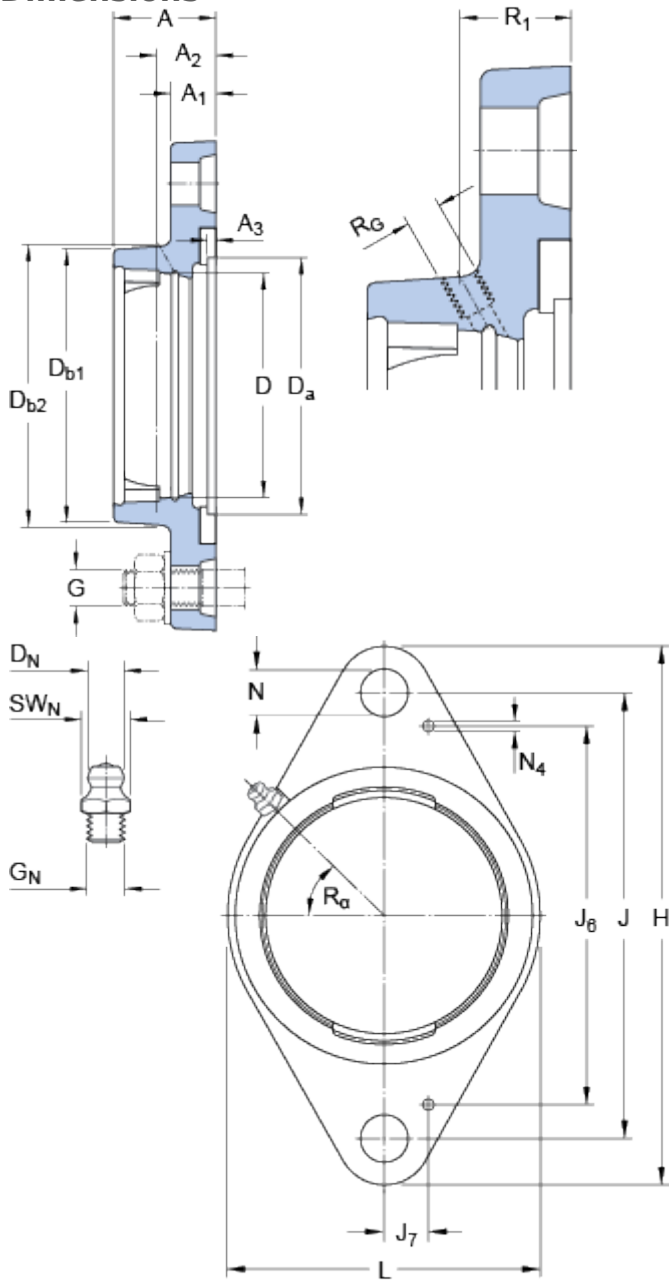

D		62	mm
D _a	H11	76.2	mm
D _{b1}		77	mm
D _{b2}		80	mm
A		30.5	mm
A ₁		13.5	mm
A ₂		18	mm
A ₃	H14	3.2	mm
J		117	mm
H		148	mm
L		80	mm
N		16	mm

Threaded hole

R _G		1/4-28 UNF
R ₁		19 mm
R _α		45 °

Grease fitting

D _N		6.5 mm
SW _N		7 mm
G _N		1/4-28 SAE-LT

Dowel pins

J ₆		99 mm
J ₇		12.5 mm
N ₄		2 mm

Mass

Mass housing	0.57	kg
--------------	------	----

Mounting information

Recommended diameter for attachment bolts, mm	G	14	mm
Recommended diameter for attachment bolts, inch	G	0.5625	in

