

# FYTB 50 TF

Housing material

Cast iron

## Dimensions

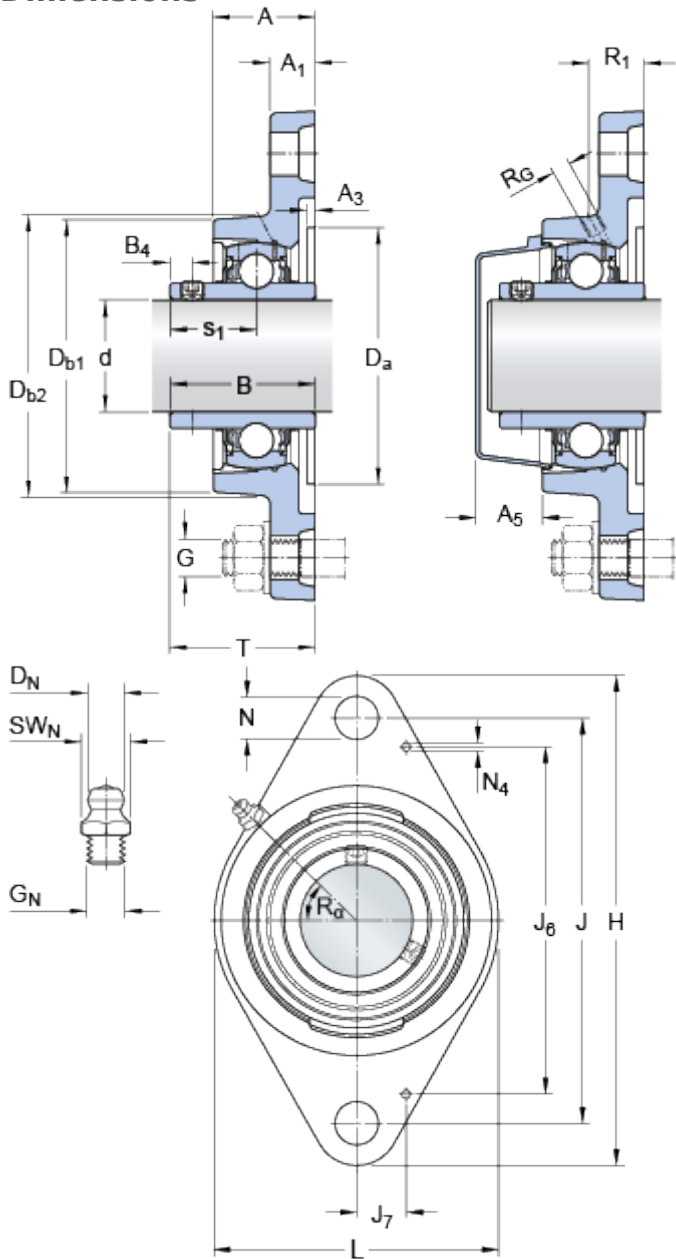

d		50	mm
D <sub>a</sub>	H11	101.6	mm
D <sub>b1</sub>		107	mm
D <sub>b2</sub>		116	mm
A		43	mm
A <sub>1</sub>		15	mm
A <sub>3</sub>	H14	3.2	mm
A <sub>5</sub>		29.5	mm
B		51.6	mm
B <sub>4</sub>		9	mm
J		157	mm
H		189	mm
L		116	mm
N		18	mm
s <sub>1</sub>		32.6	mm
T		60.6	mm

### Threaded hole

R <sub>G</sub>		1/4-28 UNF	
R <sub>1</sub>		28.5	mm
R <sub>α</sub>		45	°

### Grease fitting

D <sub>N</sub>		6.5	mm
SW <sub>N</sub>		7	mm
G <sub>N</sub>		1/4-28 SAE-LT	

### Dowel pins

J <sub>6</sub>		127	mm
J <sub>7</sub>		20	mm
N <sub>4</sub>		2	mm

## Calculation data

Basic dynamic load rating	C	35.1	kN
Basic static load rating	C	23.2	kN
Fatigue load limit	P <sub>u</sub>	0.98	kN

Limiting speed	4000	r/min
(with shaft tolerance h6)		

## Mass

Mass bearing unit	2	kg
-------------------	---	----

## Mounting information

Thread grub screw	G <sub>2</sub>	M10x1	
Hexagonal key size for grub screw	N	5	mm
Recommended tightening torque for grub screw		16.5	N·m
Recommended diameter for attachment bolts, mm	G	16	mm
Recommended diameter for attachment bolts, inch	G	0.625	in

## Included products

Housing	<a href="#">FYTB 510 M</a>
Bearing	<a href="#">YAR 210-2F</a>

## Associated products

End cover	<a href="#">ECY 210</a>
-----------	-------------------------