

# FYTB 503 M

## Dimensions

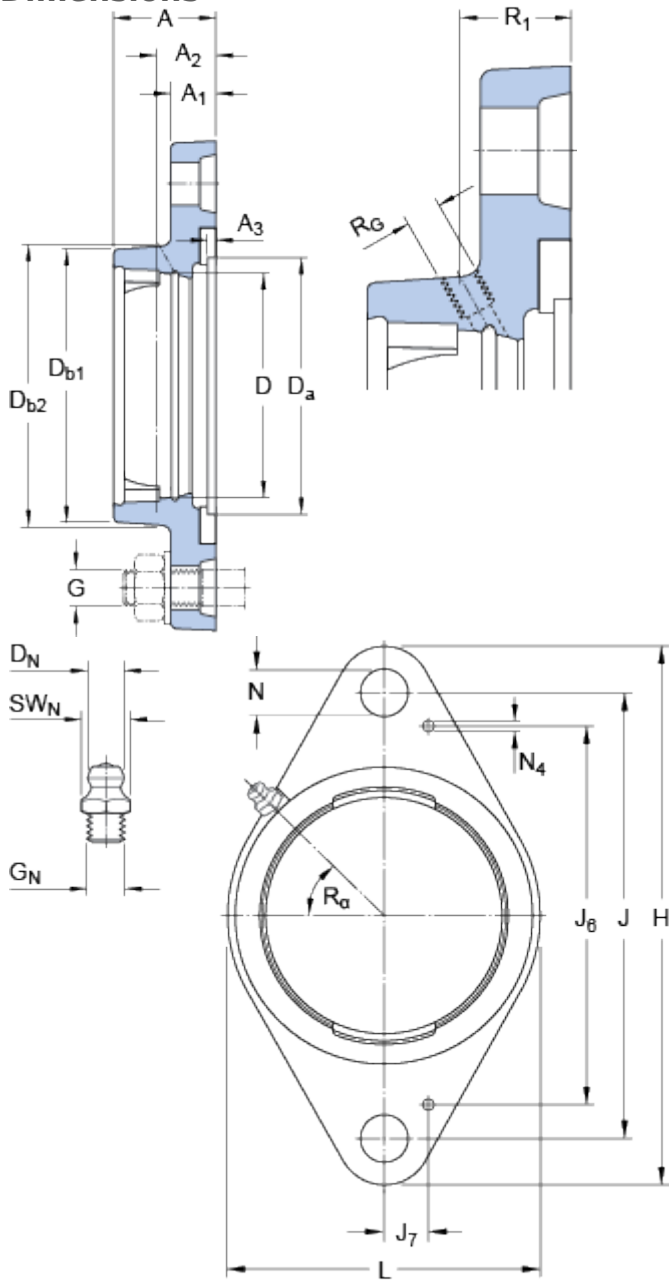

D		40	mm
D <sub>a</sub>	H11	50.8	mm
D <sub>b1</sub>		50	mm
D <sub>b2</sub>		57	mm
A		26	mm
A <sub>1</sub>		11	mm
A <sub>2</sub>		17	mm
A <sub>3</sub>	H14	3.2	mm
J		76.5	mm
H		98.5	mm
L		57	mm
N		11.5	mm

### Threaded hole

R<sub>G</sub> 1/4-28 UNF

R<sub>1</sub> 19 mm

R<sub>α</sub> 45 °

### Grease fitting

D<sub>N</sub> 6.5 mm

SW<sub>N</sub> 7 mm

G<sub>N</sub> 1/4-28 SAE-LT

### Dowel pins

J<sub>6</sub> 61.5 mm

J<sub>7</sub> 11 mm

N<sub>4</sub> 2 mm

## Mass

Mass housing 0.24 kg

## Mounting information

Recommended diameter for attachment bolts, mm G 10 mm

Recommended diameter for attachment bolts, inch G 0.375 in

