

FYTB 45 TF

Housing material

Cast iron

Dimensions

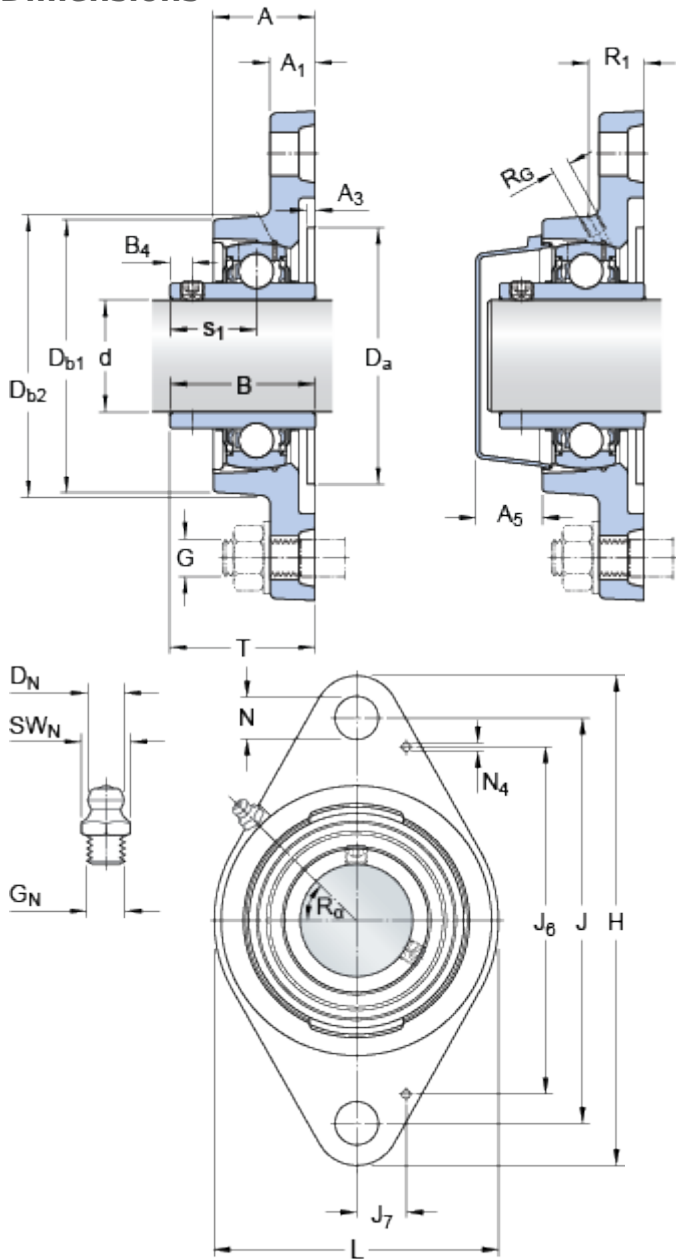

d		45	mm
D _a	H11	98.4	mm
D _{b1}		102	mm
D _{b2}		111	mm
A		39	mm
A ₁		14	mm
A ₃	H14	3.2	mm
A ₅		23	mm
B		49.2	mm
B ₄		8	mm
J		148.5	mm
H		178.5	mm
L		111	mm
N		16	mm
s ₁		30.2	mm
T		54.2	mm

Threaded hole

R _G		1/4-28 UNF	
R ₁		24.5	mm
R _α		45	°

Grease fitting

D _N		6.5	mm
SW _N		7	mm
G _N		1/4-28 SAE-LT	

Dowel pins

J ₆		120.5	mm
J ₇		18	mm
N ₄		2	mm

Calculation data

Basic dynamic load rating	C	33.2	kN
Basic static load rating	C	21.6	kN
Fatigue load limit	P _u	0.915	kN

Limiting speed	4300	r/min
(with shaft tolerance h6)		

Mass

Mass bearing unit	1.7	kg
-------------------	-----	----

Mounting information

Thread grub screw	G ₂	M8x1
Hexagonal key size for grub screw	N	4 mm
Recommended tightening torque for grub screw		6.5 N·m
Recommended diameter for attachment bolts, mm	G	14 mm
Recommended diameter for attachment bolts, inch	G	0.5625 in

Included products

Housing	FYTB 509 M
Bearing	YAR 209-2F

Associated products

End cover	ECY 209
-----------	-------------------------