

FYC 50 TF

Housing material

Cast iron

Dimensions

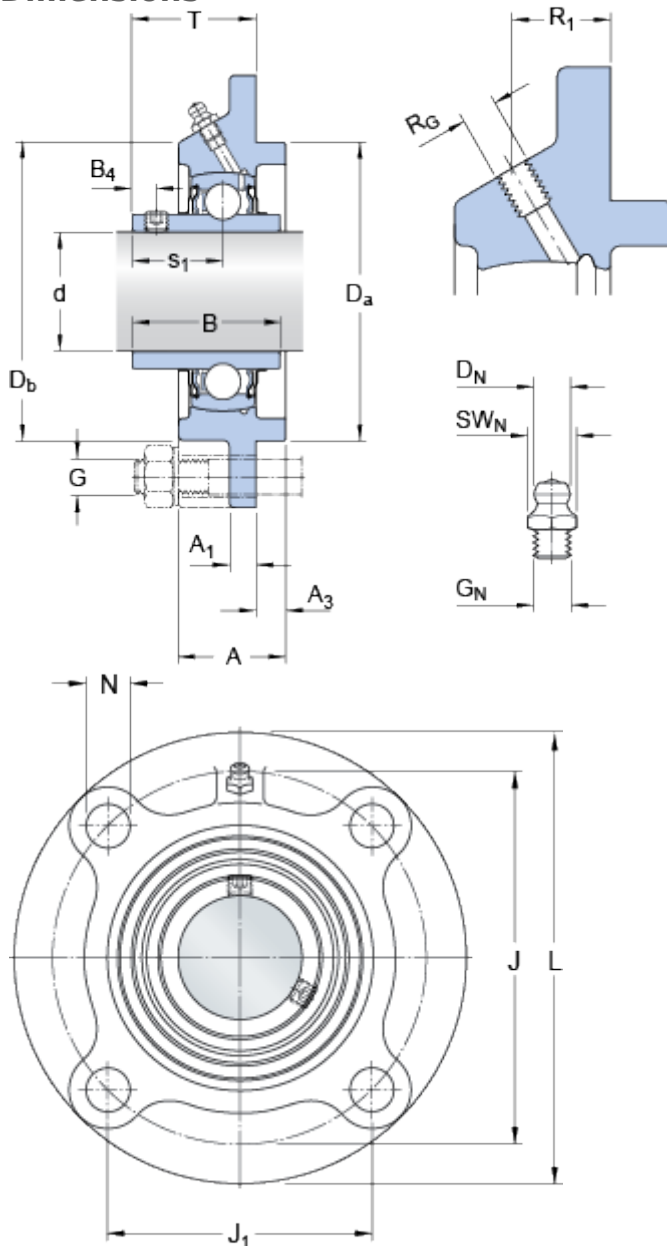

d	50	mm
A	39.5	mm
A ₁	14	mm
A ₃	12	mm
B	51.6	mm
B ₄	9	mm
D _a	h8 110	mm
D _b	113.1	mm
J	138	mm
J ₁	97.6	mm
L	165	mm
N	16	mm
s ₁	32.6	mm
T	42.6	mm

Threaded hole

R_G 1/4-28 UNF

R₁ 22 mm

Grease fitting

D_N 6.5 mm

SW_N 7 mm

G_N 1/4-28 SAE-LT

Calculation data

Basic dynamic load rating	C	35.1	kN
Basic static load rating	C	23.2	kN
Fatigue load limit	P _u	0.98	kN
Limiting speed with shaft tolerance h6		4000	r/min

Mass

Mass unit 2.85 kg

Mounting information

Thread grub screw	G ₂	M10x1	
Hexagonal key size for grub screw	N	5	mm
Recommended tightening torque for grub screw		16.5	N·m

Recommended diameter for attachment bolts, mm	G	14	mm
Recommended diameter for attachment bolts, inch	G	0.5625	in

Appertaining products

Bearing	YAR 210-2F
Housing	FYC 510