

EEB 3-2Z

Aftermarket only

Dimensions

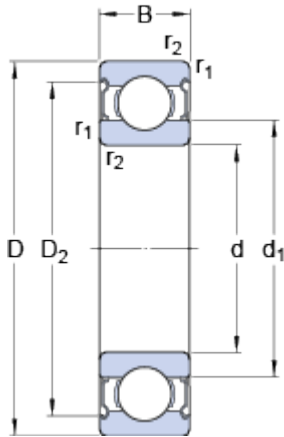

d		9.525	mm
D		22.225	mm
B		7.144	mm
d ₁	≈	12.7	mm
D ₂	≈	20	mm
r _{1,2}	min.	0.4	mm

Abutment dimensions

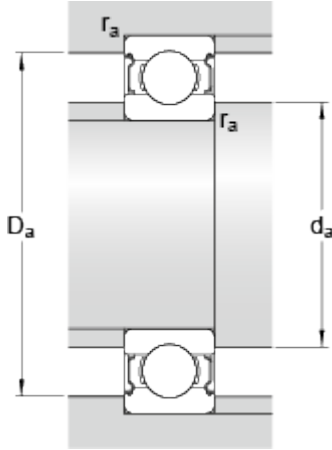

d _a	min.	11.8	mm
d _a	max.	12.6	mm
D _a	max.	19.7	mm
r _a	max.	0.4	mm

Calculation data

Basic dynamic load rating	C	3.32	kN
Basic static load rating	C	1.4	kN
Fatigue load limit	P _u	0.06	kN
Reference speed		67000	r/min
Limiting speed		34000	r/min
Calculation factor	k _r	0.025	
Calculation factor	f	12.8	

Mass

Mass bearing		0.011	kg
--------------	--	-------	----