

# AH 313 G

## Dimensions

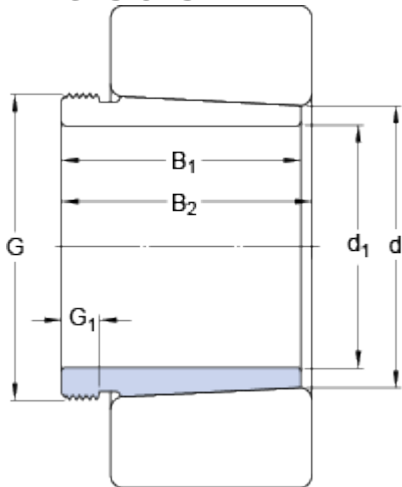

$d_1$	60	mm
$d$	65	mm
$B_1$	42	mm
$B_2$	45	mm
$G$	M 70x2	
$G_1$	8	mm

## Mass

Mass withdrawal sleeve	0.22	kg
------------------------	------	----

## Associated products

Hydraulic nut	HMV 14 E
Nut for removal	<a href="#">KM 14</a>