

AHX 3218

Dimensions

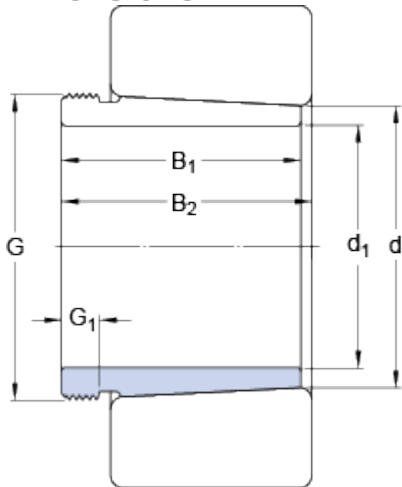

d_1	85	mm
d	90	mm
B_1	63	mm
B_2	67	mm
G	M 100x2	
G_1	10	mm

Mass

Mass withdrawal sleeve	0.57	kg
------------------------	------	----

Associated products

Hydraulic nut	HMV 20 E
Nut for removal	KM 20