

# AHX 311

## Dimensions

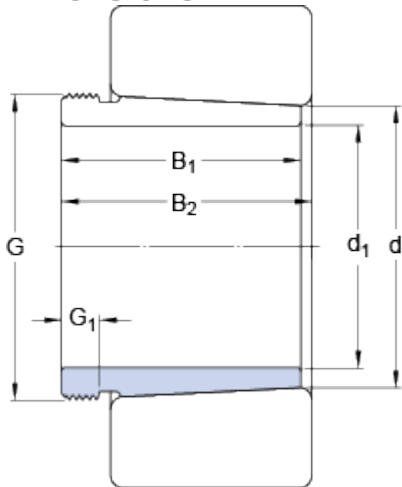

$d_1$	50	mm
$d$	55	mm
$B_1$	37	mm
$B_2$	40	mm
$G$	M 60x2	
$G_1$	7	mm

## Mass

Mass withdrawal sleeve	0.16	kg
------------------------	------	----

## Associated products

Hydraulic nut	HMV 12 E
Nut for removal	<a href="#">KM 12</a>