

AHX 2316

Dimensions

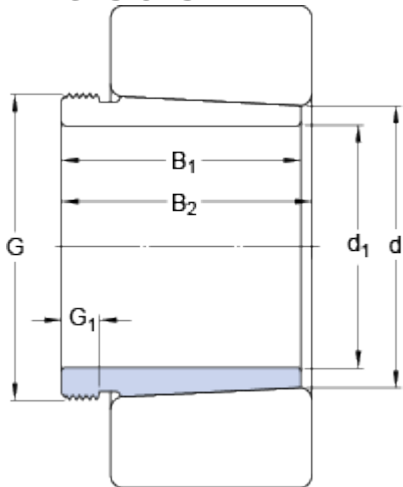

d_1	75	mm
d	80	mm
B_1	71	mm
B_2	75	mm
G	M 90x2	
G_1	12	mm

Mass

Mass withdrawal sleeve	0.57	kg
------------------------	------	----

Associated products

Hydraulic nut	HMV 18 E
Nut for removal	KM 18