

AHX 2311

Dimensions

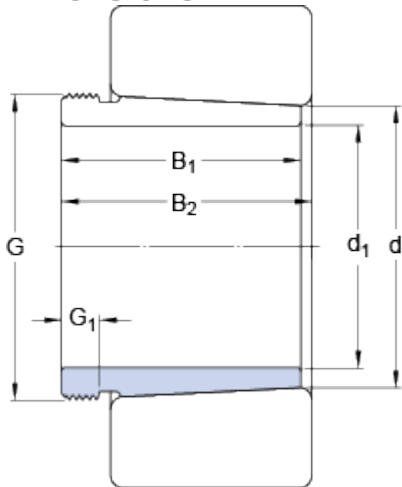

d_1	50	mm
d	55	mm
B_1	54	mm
B_2	57	mm
G	M 60x2	
G_1	10	mm

Mass

Mass withdrawal sleeve	0.26	kg
------------------------	------	----

Associated products

Hydraulic nut	HMV 12 E
Nut for removal	KM 12