

99745

Dimensions

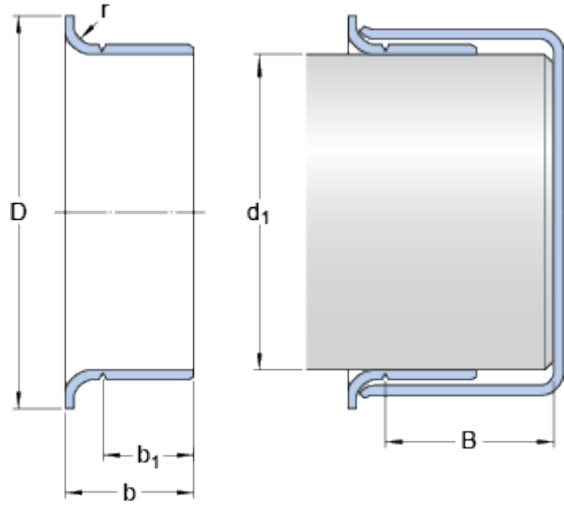

Shaft diameter range			
d_1	min.	189.078	mm
d_1	max.	189.357	mm
Nominal dimensions			
d_1		189.306	mm
D		199.644	mm
	\pm	1.6	mm
b		25.4	mm
	\pm	0.8	mm
b_1		20.65	mm
	\pm	0.8	mm
B	max.	31.75	mm
r	max.	3.18	mm