

6304-2Z

SKF Explorer

Dimensions

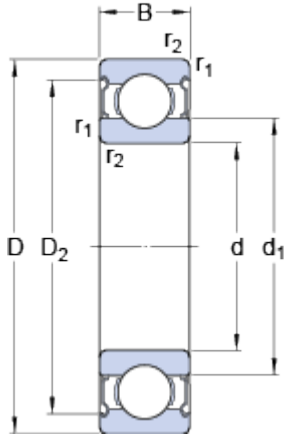

d		20	mm
D		52	mm
B		15	mm
d ₁	≈	30.35	mm
D ₂	≈	44.71	mm
r _{1,2}	min.	1.1	mm

Abutment dimensions

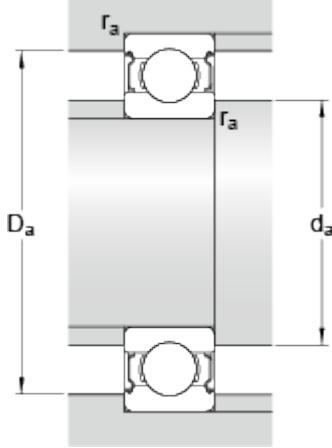

d _a	min.	27	mm
d _a	max.	30.3	mm
D _a	max.	45	mm
r _a	max.	1	mm

Calculation data

Basic dynamic load rating	C	16.8	kN
Basic static load rating	C	7.8	kN
Fatigue load limit	P _u	0.335	kN
Reference speed		30000	r/min
Limiting speed		15000	r/min
Calculation factor	k _r	0.03	
Calculation factor	f	12	

Mass

Mass bearing		0.15	kg
--------------	--	------	----