

# 6219-2Z

SKF Explorer

## Dimensions

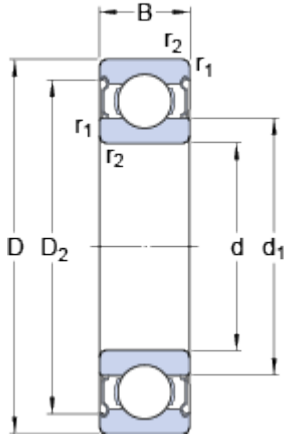

d	95	mm
D	170	mm
B	32	mm
d <sub>1</sub>	≈ 118.25	mm
D <sub>2</sub>	≈ 151.3	mm
r <sub>1,2</sub>	min. 2.1	mm

## Abutment dimensions

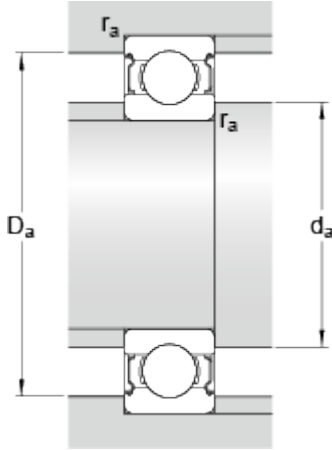

d <sub>a</sub>	min.	107	mm
d <sub>a</sub>	max.	118	mm
D <sub>a</sub>	max.	158	mm
r <sub>a</sub>	max.	2	mm

## Calculation data

Basic dynamic load rating	C	114	kN
Basic static load rating	C	81.5	kN
Fatigue load limit	P <sub>u</sub>	3	kN
Reference speed		8000	r/min
Limiting speed		4000	r/min
Calculation factor	k <sub>r</sub>	0.025	
Calculation factor	f	14.4	

## Mass

Mass bearing		2.72	kg
--------------	--	------	----