

# 6216-2Z

SKF Explorer

## Dimensions

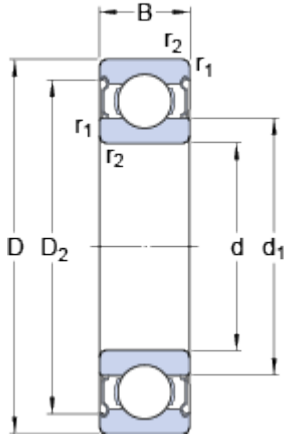

d		80	mm
D		140	mm
B		26	mm
d <sub>1</sub>	≈	101.4	mm
D <sub>2</sub>	≈	126.5	mm
r <sub>1,2</sub>	min.	2	mm

## Abutment dimensions

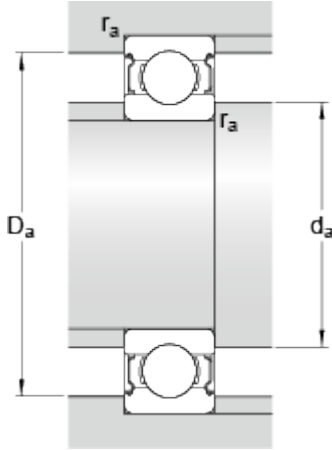

d <sub>a</sub>	min.	91	mm
d <sub>a</sub>	max.	100.9	mm
D <sub>a</sub>	max.	129	mm
r <sub>a</sub>	max.	2	mm

## Calculation data

Basic dynamic load rating	C	72.8	kN
Basic static load rating	C	55	kN
Fatigue load limit	P <sub>u</sub>	2.2	kN
Reference speed		9500	r/min
Limiting speed		4800	r/min
Calculation factor	k <sub>r</sub>	0.025	
Calculation factor	f	15	

## Mass

Mass bearing		1.53	kg
--------------	--	------	----