

# 6214-2Z

SKF Explorer

## Dimensions

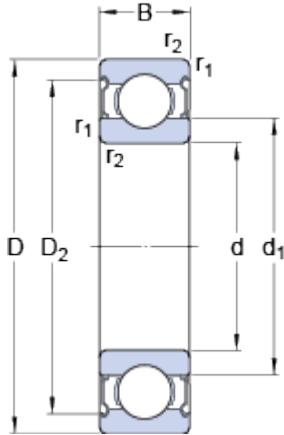

d		70	mm
D		125	mm
B		24	mm
d <sub>1</sub>	≈	87.05	mm
D <sub>2</sub>	≈	111	mm
r <sub>1,2</sub>	min.	1.5	mm

## Abutment dimensions

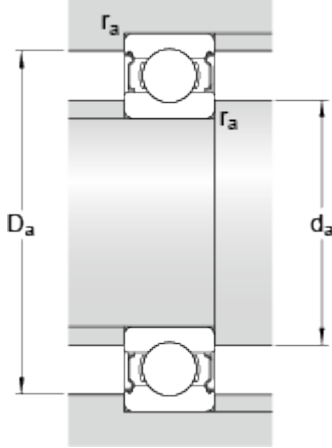

d <sub>a</sub>	min.	79	mm
d <sub>a</sub>	max.	87	mm
D <sub>a</sub>	max.	116	mm
r <sub>a</sub>	max.	1.5	mm

## Calculation data

Basic dynamic load rating	C	63.7	kN
Basic static load rating	C	45	kN
Fatigue load limit	P <sub>u</sub>	1.9	kN
Reference speed		11000	r/min
Limiting speed		5600	r/min
Calculation factor	k <sub>r</sub>	0.025	
Calculation factor	f	14.7	

## Mass

Mass bearing		1.14	kg
--------------	--	------	----