

61904-2RZ

Dimensions

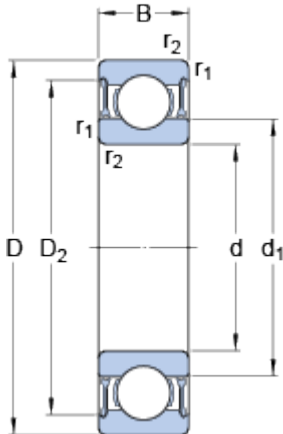

d		20	mm
D		37	mm
B		9	mm
d ₁	≈	25.55	mm
D ₂	≈	32.7	mm
r _{1,2}	min.	0.3	mm

Abutment dimensions

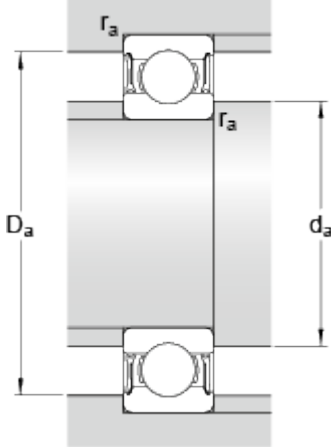

d _a	min.	22	mm
d _a	max.	25.5	mm
D _a	max.	35	mm
r _a	max.	0.3	mm

Calculation data

Basic dynamic load rating	C	6.37	kN
Basic static load rating	C	3.65	kN
Fatigue load limit	P _u	0.156	kN
Reference speed		43000	r/min
Limiting speed		20000	r/min
Calculation factor	k _r	0.02	
Calculation factor	f	14.7	

Mass

Mass bearing		0.038	kg
--------------	--	-------	----