

# 61816-2RS1

## Dimensions

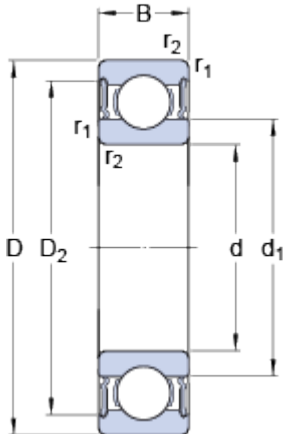

d		80	mm
D		100	mm
B		10	mm
d <sub>1</sub>	≈	86.7	mm
D <sub>2</sub>	≈	95.7	mm
r <sub>1,2</sub>	min.	1.3	mm

## Abutment dimensions



d <sub>a</sub>	min.	83.2	mm
d <sub>a</sub>	max.	86.5	mm
D <sub>a</sub>	max.	96.8	mm
r <sub>a</sub>	max.	0.6	mm

## Calculation data

Basic dynamic load rating	C	12.7	kN
Basic static load rating	C	11.2	kN
Fatigue load limit	P <sub>u</sub>	0.61	kN
Limiting speed		3600	r/min
Calculation factor	k <sub>r</sub>	0.015	
Calculation factor	f	13.3	

## Mass

Mass bearing		0.16	kg
--------------	--	------	----