

61806-2RZ

Dimensions

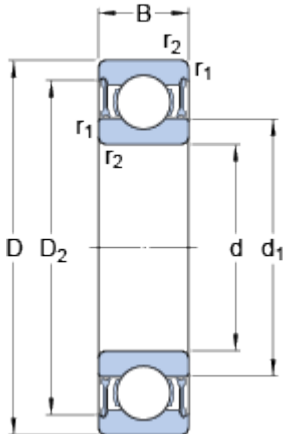

d		30	mm
D		42	mm
B		7	mm
d ₁	≈	33.7	mm
D ₂	≈	39.4	mm
r _{1,2}	min.	0.6	mm

Abutment dimensions

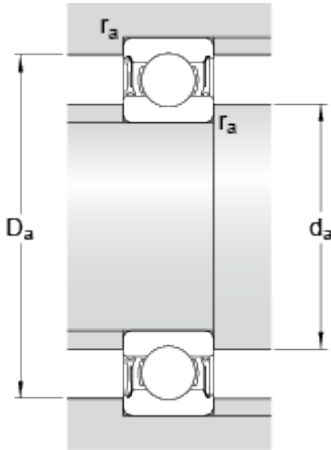

d _a	min.	32	mm
d _a	max.	33.6	mm
D _a	max.	40	mm
r _a	max.	0.3	mm

Calculation data

Basic dynamic load rating	C	4.49	kN
Basic static load rating	C	2.9	kN
Fatigue load limit	P _u	0.146	kN
Reference speed		32000	r/min
Limiting speed		16000	r/min
Calculation factor	k _r	0.015	
Calculation factor	f	13.9	

Mass

Mass bearing		0.025	kg
--------------	--	-------	----