

# 61802-2Z

## Dimensions

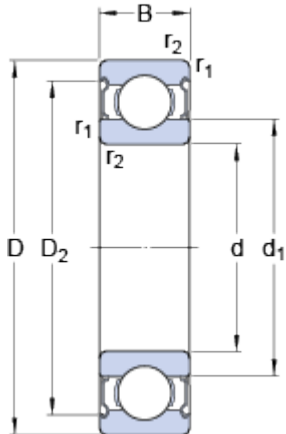

d		15	mm
D		24	mm
B		5	mm
d <sub>1</sub>	≈	17.8	mm
D <sub>2</sub>	≈	22.15	mm
r <sub>1,2</sub>	min.	0.3	mm

## Abutment dimensions

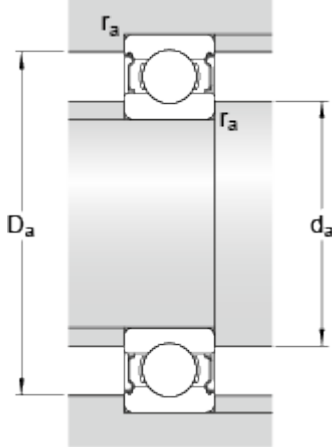

d <sub>a</sub>	min.	17	mm
d <sub>a</sub>	max.	17.8	mm
D <sub>a</sub>	max.	22	mm
r <sub>a</sub>	max.	0.3	mm

## Calculation data

Basic dynamic load rating	C	1.9	kN
Basic static load rating	C	1.1	kN
Fatigue load limit	P <sub>u</sub>	0.048	kN
Reference speed		60000	r/min
Limiting speed		30000	r/min
Calculation factor	k <sub>r</sub>	0.015	
Calculation factor	f	13.8	

## Mass

Mass bearing		0.0074	kg
--------------	--	--------	----