

# 61801-2Z

## Dimensions

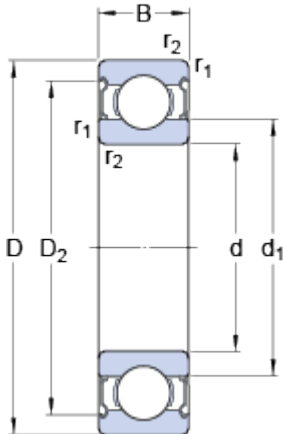

d		12	mm
D		21	mm
B		5	mm
d <sub>1</sub>	≈	14.8	mm
D <sub>2</sub>	≈	18.95	mm
r <sub>1,2</sub>	min.	0.3	mm

## Abutment dimensions

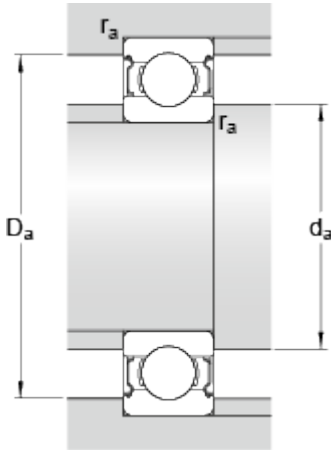

d <sub>a</sub>	min.	14	mm
d <sub>a</sub>	max.	14.7	mm
D <sub>a</sub>	max.	19	mm
r <sub>a</sub>	max.	0.3	mm

## Calculation data

Basic dynamic load rating	C	1.74	kN
Basic static load rating	C	0.915	kN
Fatigue load limit	P <sub>u</sub>	0.039	kN
Reference speed		70000	r/min
Limiting speed		36000	r/min
Calculation factor	k <sub>r</sub>	0.015	
Calculation factor	f	13.4	

## Mass

Mass bearing		0.0063	kg
--------------	--	--------	----