

61800-2RS1

Dimensions

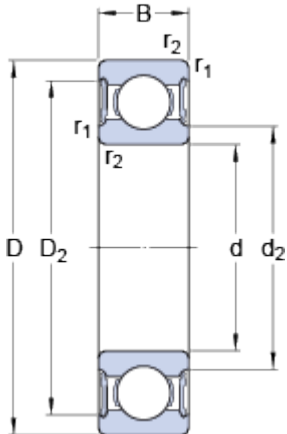

d		10	mm
D		19	mm
B		5	mm
d ₂	≈	11.8	mm
D ₂	≈	17.15	mm
r _{1,2}	min.	0.3	mm

Abutment dimensions

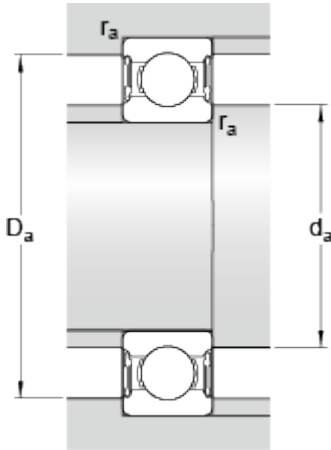

d _a	min.	11.8	mm
d _a	max.	11.8	mm
D _a	max.	17	mm
r _a	max.	0.3	mm

Calculation data

Basic dynamic load rating	C	1.72	kN
Basic static load rating	C	0.83	kN
Fatigue load limit	P _u	0.036	kN
Limiting speed		22000	r/min
Calculation factor	k _r	0.015	
Calculation factor	f	14.8	

Mass

Mass bearing		0.0055	kg
--------------	--	--------	----