

# 6012-2Z

SKF Explorer

## Dimensions

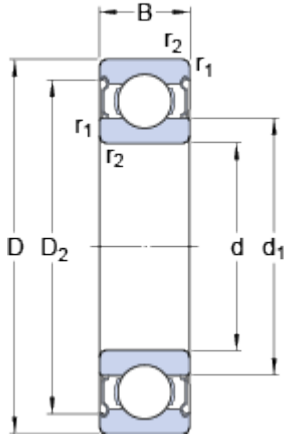

d		60	mm
D		95	mm
B		18	mm
d <sub>1</sub>	≈	71.3	mm
D <sub>2</sub>	≈	86.5	mm
r <sub>1,2</sub>	min.	1.1	mm

## Abutment dimensions

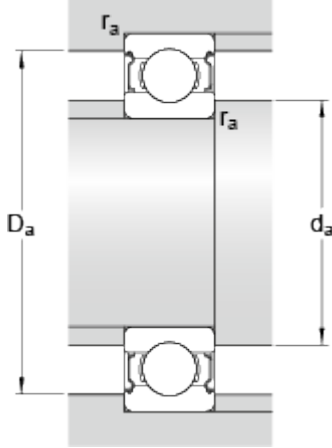

d <sub>a</sub>	min.	66	mm
d <sub>a</sub>	max.	71.2	mm
D <sub>a</sub>	max.	89	mm
r <sub>a</sub>	max.	1	mm

## Calculation data

Basic dynamic load rating	C	30.7	kN
Basic static load rating	C	23.2	kN
Fatigue load limit	P <sub>u</sub>	0.98	kN
Reference speed		15000	r/min
Limiting speed		7500	r/min
Calculation factor	k <sub>r</sub>	0.025	
Calculation factor	f	15.6	

## Mass

Mass bearing		0.43	kg
--------------	--	------	----