

51309

Dimensions

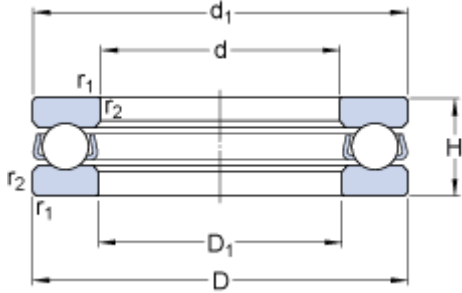

d		45	mm
D		85	mm
H		28	mm
d ₁	≈	85	mm
D ₁	≈	47	mm
r _{1,2}	min.	1	mm

Abutment dimensions

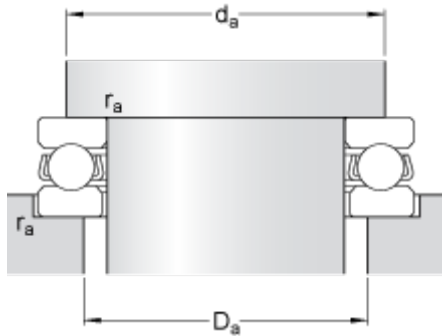

d _a	min.	69	mm
D _a	max.	61	mm
r _a	max.	1	mm

Calculation data

Basic dynamic load rating	C	76.1	kN
Basic static load rating	C	153	kN
Fatigue load limit	P _u	5.6	kN
Reference speed		2800	r/min
Limiting speed		4000	r/min
Minimum load factor	A	0.12	

Mass

Mass bearing (including seat washer where applicable)		0.66	kg
---	--	------	----