

51113

Dimensions

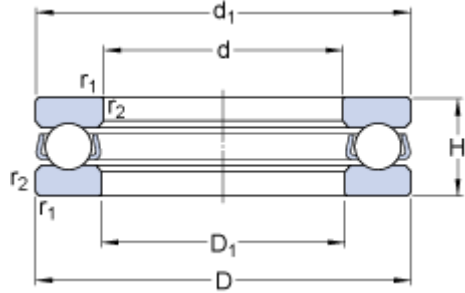

d		65	mm
D		90	mm
H		18	mm
d ₁	≈	90	mm
D ₁	≈	67	mm
r _{1,2}	min.	1	mm

Abutment dimensions

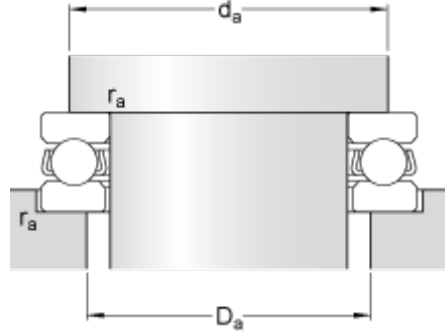

d _a	min.	80	mm
D _a	max.	75	mm
r _a	max.	1	mm

Calculation data

Basic dynamic load rating	C	37.7	kN
Basic static load rating	C	108	kN
Fatigue load limit	P _u	4	kN
Reference speed		3400	r/min
Limiting speed		4800	r/min
Minimum load factor	A	0.06	

Mass

Mass bearing (including seat washer where applicable)		0.33	kg
---	--	------	----