

# 51108

## Dimensions

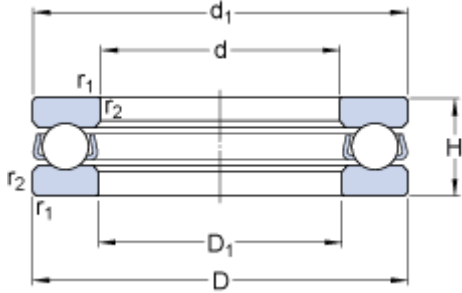

d	40	mm
D	60	mm
H	13	mm
d <sub>1</sub>	≈ 60	mm
D <sub>1</sub>	≈ 42	mm
r <sub>1,2</sub>	min. 0.6	mm

## Abutment dimensions

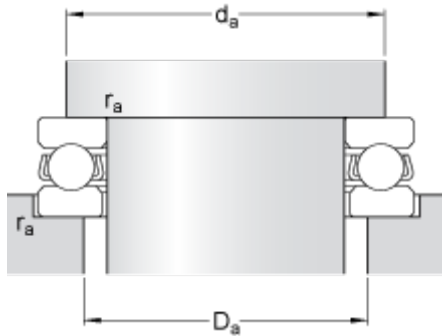

d <sub>a</sub>	min. 52	mm
D <sub>a</sub>	max. 48	mm
r <sub>a</sub>	max. 0.6	mm

## Calculation data

Basic dynamic load rating	C	25.5	kN
Basic static load rating	C	63	kN
Fatigue load limit	P <sub>u</sub>	2.32	kN
Reference speed		5000	r/min
Limiting speed		7000	r/min
Minimum load factor	A	0.02	

## Mass

Mass bearing (including seat washer where applicable)	0.12	kg
---	------	----