

212-Z

Dimensions

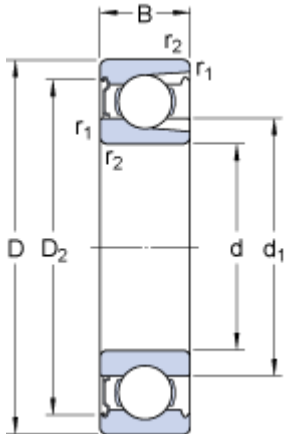

d		60	mm
D		110	mm
B		22	mm
d ₁	≈	75.5	mm
D ₂	≈	98	mm
r _{1,2}	min.	1.5	mm

Abutment dimensions

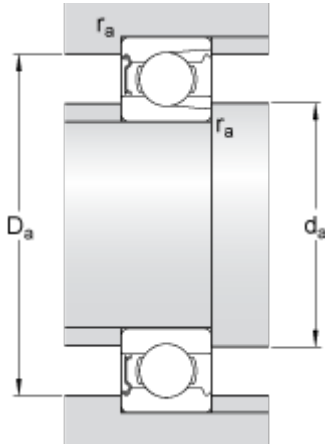

d _a	min.	69	mm
d _a	max.	75.4	mm
D _a	max.	101	mm
r _a	max.	1.5	mm

Calculation data

Basic dynamic load rating	C	56.1	kN
Basic static load rating	C	50	kN
Fatigue load limit	P _u	2.12	kN
Reference speed		11000	r/min
Limiting speed		6700	r/min
Calculation factor	k _r	0.04	

Mass

Mass bearing		0.85	kg
--------------	--	------	----