

# 1726307-2RS1

## Dimensions

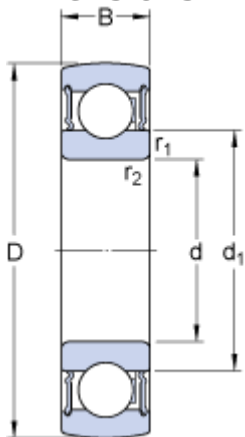

d	35	mm
D	80	mm
B	21	mm
d <sub>1</sub>	≈ 49.56	mm
r <sub>1,2</sub>	min. 1.5	mm

## Calculation data

Basic dynamic load rating	C	33.2	kN
Basic static load rating	C	19	kN
Fatigue load limit	P <sub>u</sub>	0.815	kN
Limiting speed <sup>1)</sup>		6000	r/min
Calculation factor	f	13	

## Mass

Mass complete bearing		0.44	kg
-----------------------	--	------	----