

1726206-2RS1

Dimensions

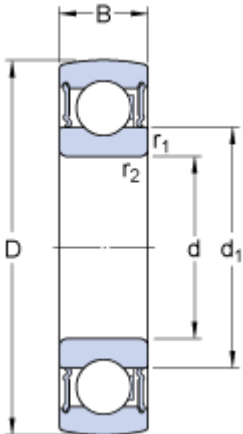

d	30	mm
D	62	mm
B	16	mm
d ₁	≈ 40.36	mm
r _{1,2}	min. 1	mm

Calculation data

Basic dynamic load rating	C	19.5	kN
Basic static load rating	C	11.2	kN
Fatigue load limit	P _u	0.475	kN
Limiting speed ¹⁾		7500	r/min
Calculation factor	f	14	

Mass

Mass complete bearing		0.19	kg
-----------------------	--	------	----

Associated products

Rubber seating ring		RIS 206 A	
---------------------	--	---------------------------	--