

# 1315 K

## Dimensions

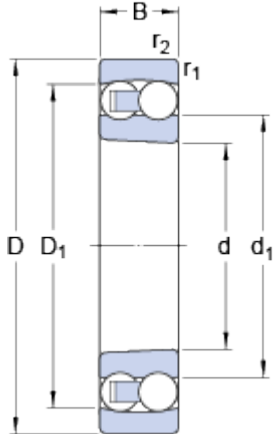

d		75	mm
D		160	mm
B		37	mm
d <sub>1</sub>	≈	104.8	mm
D <sub>1</sub>	≈	135.2	mm
r <sub>1,2</sub>	min.	2.1	mm

Tapered bore, taper 1:12

## Abutment dimensions

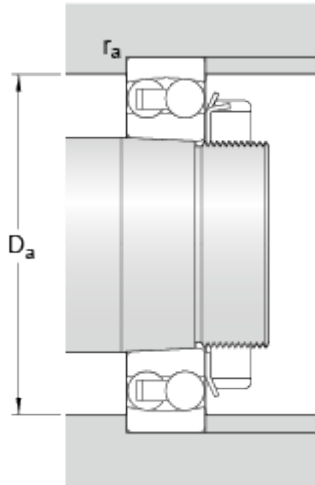

D <sub>a</sub>	max.	148	mm
r <sub>a</sub>	max.	2	mm

## Calculation data

Basic dynamic load rating	C	79.3	kN
Basic static load rating	C	30	kN
Fatigue load limit	P <sub>u</sub>	1.43	kN
Reference speed		8000	r/min
Limiting speed		5600	r/min
Permissible angular misalignment	α	3	°
Calculation factor	k <sub>r</sub>	0.045	
Calculation factor	e	0.22	
Calculation factor	Y	2.8	
Calculation factor	Y <sub>1</sub>	2.9	
Calculation factor	Y <sub>2</sub>	4.5	

## Mass

Mass bearing		3.4	kg
--------------	--	-----	----

