

1222 K

Dimensions

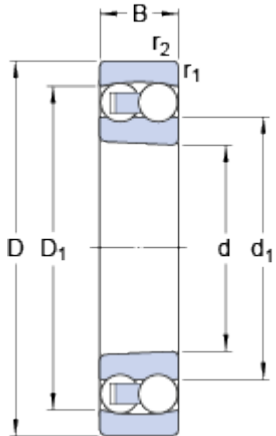

d	110	mm
D	200	mm
B	38	mm
d_1	≈ 140.35	mm
D_1	≈ 173.7	mm
$r_{1,2}$	min. 2.1	mm

Tapered bore, taper 1:12

Abutment dimensions

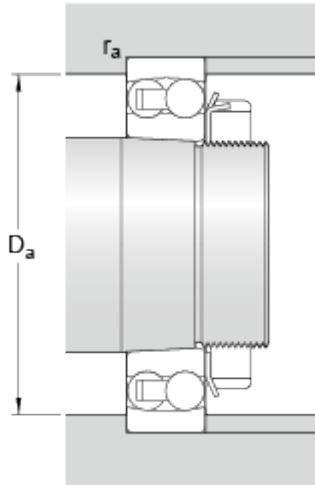

D_a	max.	188	mm
r_a	max.	2	mm

Calculation data

Basic dynamic load rating	C	88.4	kN
Basic static load rating	C	39	kN
Fatigue load limit	P_u	1.6	kN
Reference speed		6700	r/min
Limiting speed		4300	r/min
Permissible angular misalignment	α	2.5	°
Calculation factor	k_r	0.04	
Calculation factor	e	0.17	
Calculation factor	Y	4	
Calculation factor	Y_1	3.7	
Calculation factor	Y_2	5.7	

Mass

Mass bearing		5	kg
--------------	--	---	----

