

1219 K

Dimensions

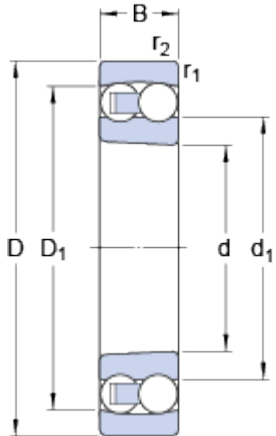

d		95	mm
D		170	mm
B		32	mm
d ₁	≈	120.4	mm
D ₁	≈	148.1	mm
r _{1,2}	min.	2.1	mm

Tapered bore, taper 1:12

Abutment dimensions

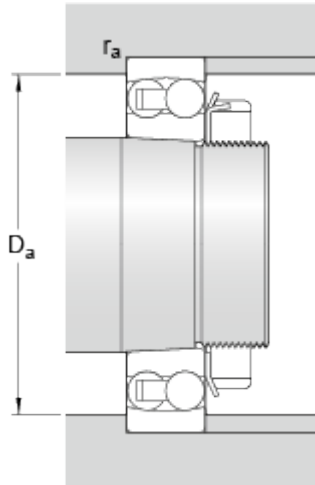

D _a	max.	158	mm
r _a	max.	2	mm

Calculation data

Basic dynamic load rating	C	63.7	kN
Basic static load rating	C	27	kN
Fatigue load limit	P _u	1.2	kN
Reference speed		8000	r/min
Limiting speed		5000	r/min
Permissible angular misalignment	α	2.5	°
Calculation factor	k _r	0.04	
Calculation factor	e	0.17	
Calculation factor	Y	4	
Calculation factor	Y ₁	3.7	
Calculation factor	Y ₂	5.7	

Mass

Mass bearing		3.1	kg
--------------	--	-----	----

