

1217 K

Dimensions

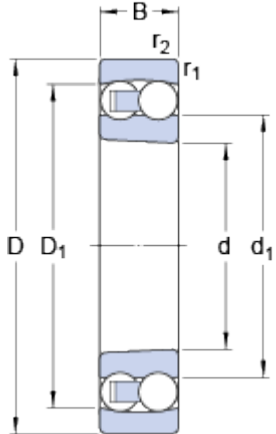

d	85	mm
D	150	mm
B	28	mm
d ₁	≈ 107	mm
D ₁	≈ 131	mm
r _{1,2}	min. 2	mm

Tapered bore, taper 1:12

Abutment dimensions

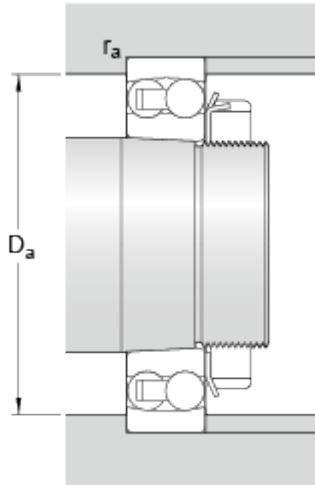

D _a	max.	139	mm
r _a	max.	2	mm

Calculation data

Basic dynamic load rating	C	48.8	kN
Basic static load rating	C	20.8	kN
Fatigue load limit	P _u	0.98	kN
Reference speed		9000	r/min
Limiting speed		5600	r/min
Permissible angular misalignment	α	2.5	°
Calculation factor	k _r	0.04	
Calculation factor	e	0.17	
Calculation factor	Y	4	
Calculation factor	Y ₁	3.7	
Calculation factor	Y ₂	5.7	

Mass

Mass bearing		2	kg
--------------	--	---	----

