

# 1212 EKTN9

## Dimensions

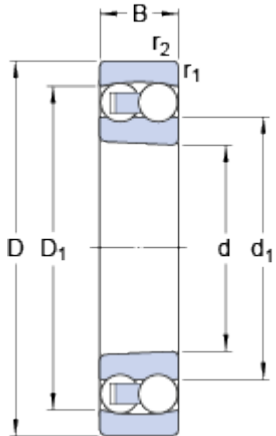

d	60	mm
D	110	mm
B	22	mm
d <sub>1</sub>	≈ 78	mm
D <sub>1</sub>	≈ 95.6	mm
r <sub>1,2</sub>	min. 1.5	mm

Tapered bore, taper 1:12

## Abutment dimensions

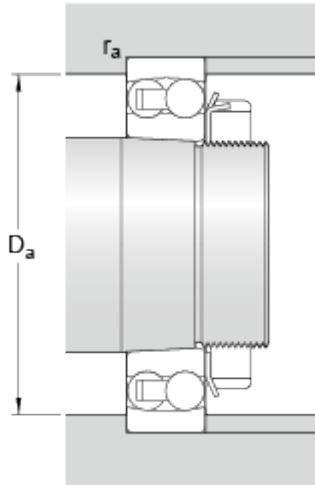

D <sub>a</sub>	max.	101	mm
r <sub>a</sub>	max.	1.5	mm

## Calculation data

Basic dynamic load rating	C	31.2	kN
Basic static load rating	C	12.2	kN
Fatigue load limit	P <sub>u</sub>	0.62	kN
Reference speed		12000	r/min
Limiting speed		8500	r/min
Permissible angular misalignment	α	2.5	°
Calculation factor	k <sub>r</sub>	0.04	
Calculation factor	e	0.19	
Calculation factor	Y	3.6	
Calculation factor	Y <sub>1</sub>	3.3	
Calculation factor	Y <sub>2</sub>	5.1	

## Mass

Mass bearing		0.9	kg
--------------	--	-----	----

